

296

WYTHE AVENUE

AKA 74 NORTH 1ST STREET
WILLIAMSBURG, BROOKLYN

Between North 1st & Grand Streets

RETAIL FOR LEASE

APPROXIMATE SIZE

4,300 SF

ASKING RENT

\$120 PSF

POSSESSION

Immediate

TERM

Negotiable

FRONTAGE

75 FT

COMMENTS

- Prime retail space at the base of a newly developed 38-unit luxury residential building
- In the heart of Williamsburg's top retail, restaurant, and lifestyle brand corridors
- Soaring 14' ceilings
- High visibility and signage opportunity
- Located steps from Domino Park and the Domino Sugar re-development
- Join in-building tenants Joe & The Juice and Heyday
- Logical divisions considered

NEIGHBORS

Heyday Skincare • Joe & The Juice • Gelateria Gentile • Ume • The Cactus Shop • Bar Baserri • Isla & Co. • Two Hands • Jack's Wife Freda • Roberta's • MISIPASTA • Radegast Hall & Biergarten

TRANSPORTATION



JAMES FAMULARO

President
646.658.7373
jfamularo@meridiancapital.com

JORDAN LANGER

Senior Associate
212.468.5977
jlanger@meridiancapital.com



CONCEPTUAL RENDERING



MERIDIAN
RETAIL LEASING

All information supplied is from sources deemed reliable and is furnished subject to errors, omissions, modifications, removal of the listing from sale or lease, and to any listing conditions, including the rates and manner of payment of commissions for particular offerings imposed by Meridian Capital Group. This information may include estimates and projections prepared by Meridian Capital Group with respect to future events, and these future events may or may not actually occur. Such estimates and projections reflect various assumptions concerning anticipated results. While Meridian Capital Group believes these assumptions are reasonable, there can be no assurance that any of these estimates and projections will be correct. Therefore, actual results may vary materially from these estimates and projections. Any square footage dimensions set forth are approximate.

296 WYTHE AVENUE

WILLIAMSBURG, BROOKLYN | Between North 1st and Grand Streets

RETAIL FOR LEASE



INTERIOR

JAMES FAMULARO

President
646.658.7373
jfamularo@meridiancapital.com

JORDAN LANGER

Senior Associate
212.468.5977
jlanger@meridiancapital.com



MERIDIAN
RETAIL LEASING

All information supplied is from sources deemed reliable and is furnished subject to errors, omissions, modifications, removal of the listing from sale or lease, and to any listing conditions, including the rates and manner of payment of commissions for particular offerings imposed by Meridian Capital Group. This information may include estimates and projections prepared by Meridian Capital Group with respect to future events, and these future events may or may not actually occur. Such estimates and projections reflect various assumptions concerning anticipated results. While Meridian Capital Group believes these assumptions are reasonable, there can be no assurance that any of these estimates and projections will be correct. Therefore, actual results may vary materially from these estimates and projections. Any square footage dimensions set forth are approximate.

296 WYTHE AVENUE

WILLIAMSBURG, BROOKLYN | Between North 1st and Grand Streets

RETAIL FOR LEASE

FLOOR PLAN

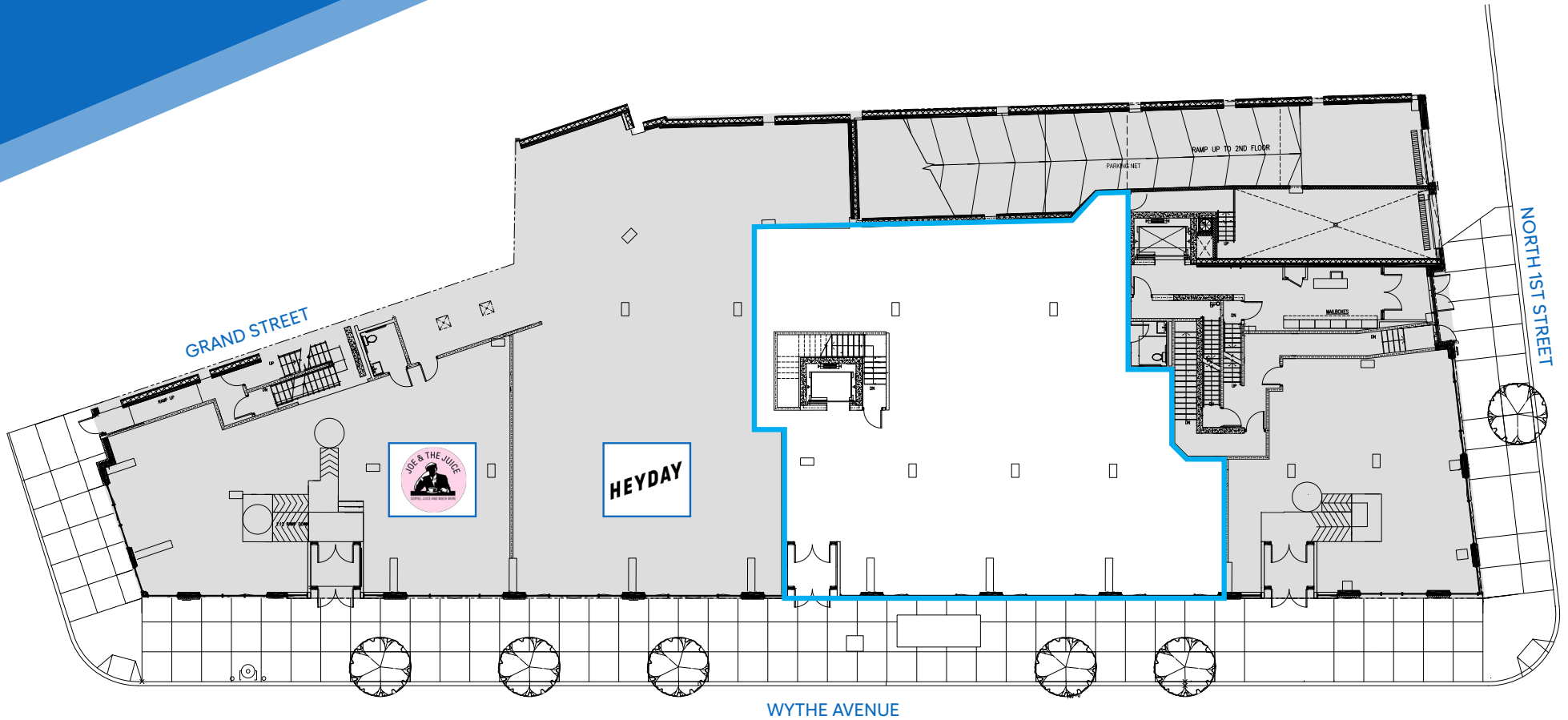

JAMES FAMULARO

President
646.658.7373
jfamularo@meridiancapital.com

JORDAN LANGER

Senior Associate
212.468.5977
jlanger@meridiancapital.com



MERIDIAN
RETAIL LEASING

All information supplied is from sources deemed reliable and is furnished subject to errors, omissions, modifications, removal of the listing from sale or lease, and to any listing conditions, including the rates and manner of payment of commissions for particular offerings imposed by Meridian Capital Group. This information may include estimates and projections prepared by Meridian Capital Group with respect to future events, and these future events may or may not actually occur. Such estimates and projections reflect various assumptions concerning anticipated results. While Meridian Capital Group believes these assumptions are reasonable, there can be no assurance that any of these estimates and projections will be correct. Therefore, actual results may vary materially from these estimates and projections. Any square footage dimensions set forth are approximate.

296 WYTHE AVENUE

WILLIAMSBURG, BROOKLYN | Between North 1st and Grand Streets

RETAIL FOR LEASE

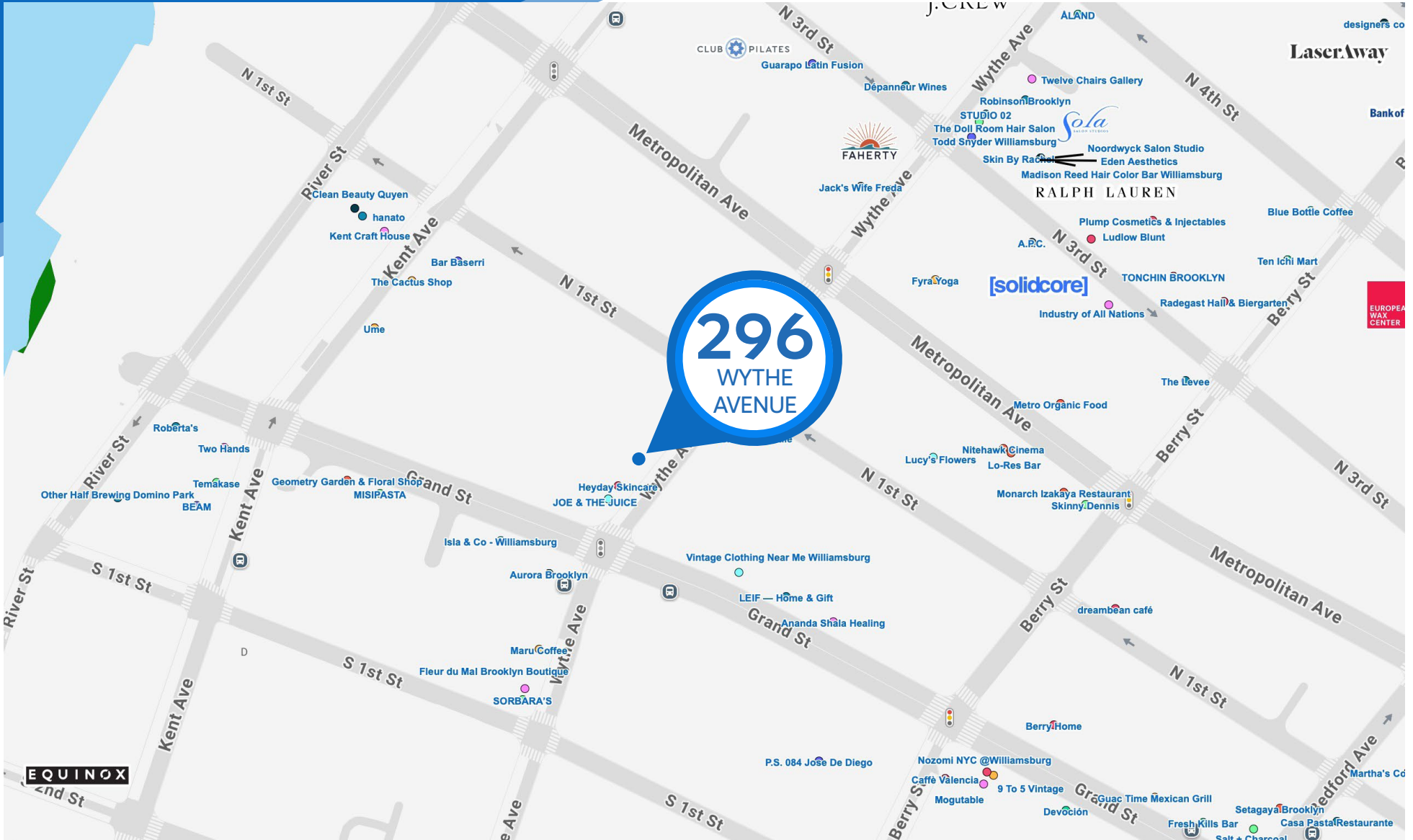

NEIGHBORS

JAMES FAMULARO

President
646.658.7373
jfamularo@meridiancapital.com

JORDAN LANGER

Senior Associate
212.468.5977
jlanger@meridiancapital.com



MERIDIAN
RETAIL LEASING

All information supplied is from sources deemed reliable and is furnished subject to errors, omissions, modifications, removal of the listing from sale or lease, and to any listing conditions, including the rates and manner of payment of commissions for particular offerings imposed by Meridian Capital Group. This information may include estimates and projections prepared by Meridian Capital Group with respect to future events, and these future events may or may not actually occur. Such estimates and projections reflect various assumptions concerning anticipated results. While Meridian Capital Group believes these assumptions are reasonable, there can be no assurance that any of these estimates and projections will be correct. Therefore, actual results may vary materially from these estimates and projections. Any square footage dimensions set forth are approximate.