

305

EAST FORDHAM ROAD
FORDHAM, BRONX

Corner of East Fordham & East Kingsbridge Roads

RETAIL FOR LEASE

APPROXIMATE SIZE

3,950 SF

CEILING HEIGHT

15 FT

ASKING RENT

~~\$150 PSF~~ **Reduced**
\$120 PSF

POSSESSION

Immediate

TERM

Negotiable

FRONTAGE

25 FT

COMMENTS

- Perfect layout for healthcare, insurance, or service-oriented retail
- Flexible layout
- Highly visible corner with heavy foot traffic fueled by residency and daytime population

NEIGHBORS

Gap • Wing Stop • Kids Foot Locker • Target
• Verizon • Popeyes • Cinnabon • VIM •
Gong Cha • Wendy's • Chipotle • Rainbow
• PC Richard & Son • Chick-Fil-A

TRANSPORTATION



NOAM AZIZ

Senior Director
212.468.5984
naziz@meridiancapital.com

STEPHEN LIGAMBI

Senior Associate
212.468.5985
sligambi@meridiancapital.com

SHAYA KATZ

Associate
212.468.5991
shaya.katz@meridiancapital.com



MERIDIAN
RETAIL LEASING

All information supplied is from sources deemed reliable and is furnished subject to errors, omissions, modifications, removal of the listing from sale or lease, and to any listing conditions, including the rates and manner of payment of commissions for particular offerings imposed by Meridian Capital Group. This information may include estimates and projections prepared by Meridian Capital Group with respect to future events, and these future events may or may not actually occur. Such estimates and projections reflect various assumptions concerning anticipated results. While Meridian Capital Group believes these assumptions are reasonable, there can be no assurance that any of these estimates and projections will be correct. Therefore, actual results may vary materially from these estimates and projections. Any square footage dimensions set forth are approximate.

305 EAST FORDHAM ROAD

FORDHAM, BRONX | Corner of East Fordham and East Kingsbridge Roads

RETAIL FOR LEASE



INTERIOR

NOAM AZIZ
Senior Director
212.468.5984
naziz@meridiancapital.com

STEPHEN LIGAMBI
Senior Associate
212.468.5985
sligambi@meridiancapital.com

SHAYA KATZ
Associate
212.468.5991
shaya.katz@meridiancapital.com



MERIDIAN
RETAIL LEASING

All information supplied is from sources deemed reliable and is furnished subject to errors, omissions, modifications, removal of the listing from sale or lease, and to any listing conditions, including the rates and manner of payment of commissions for particular offerings imposed by Meridian Capital Group. This information may include estimates and projections prepared by Meridian Capital Group with respect to future events, and these future events may or may not actually occur. Such estimates and projections reflect various assumptions concerning anticipated results. While Meridian Capital Group believes these assumptions are reasonable, there can be no assurance that any of these estimates and projections will be correct. Therefore, actual results may vary materially from these estimates and projections. Any square footage dimensions set forth are approximate.

305 EAST FORDHAM ROAD

FORDHAM, BRONX | Corner of East Fordham and East Kingsbridge Roads

RETAIL FOR LEASE

FLOOR PLAN

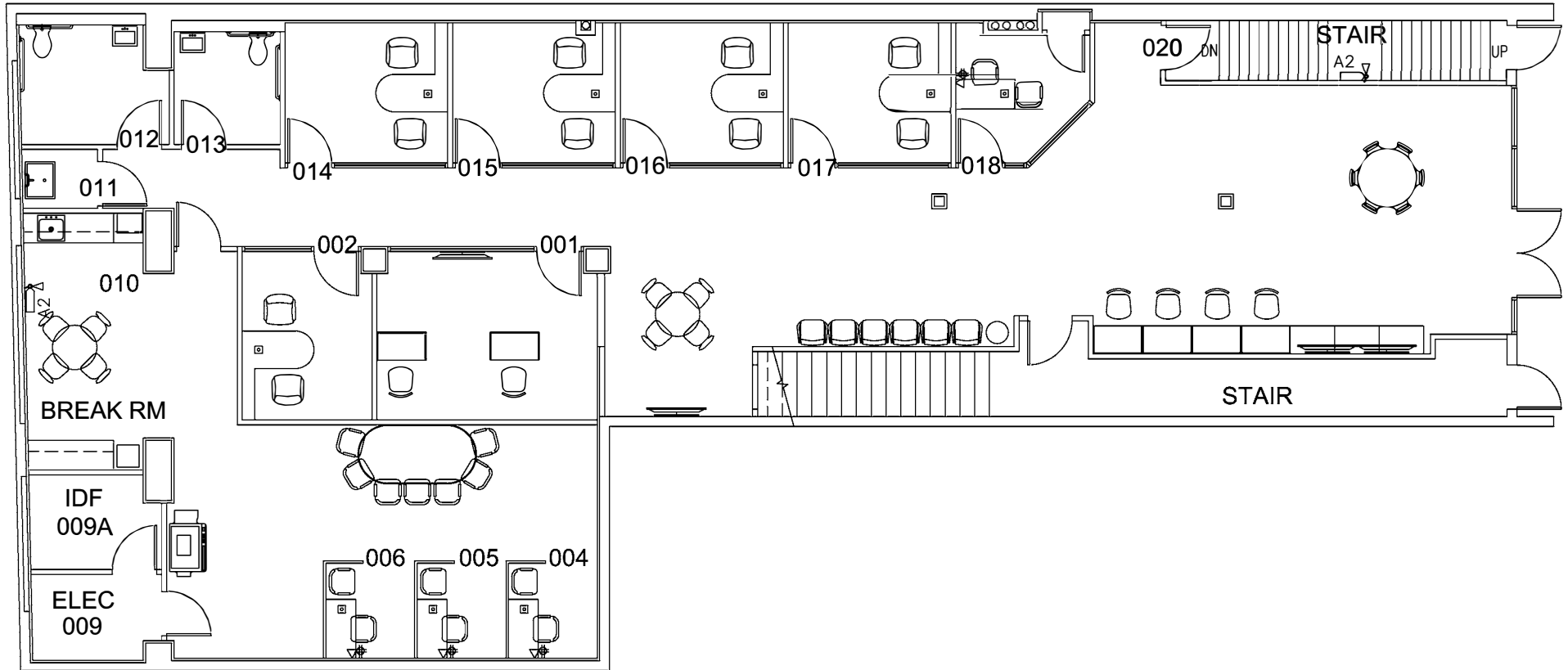

NOAM AZIZ
Senior Director
212.468.5984
naziz@meridiancapital.com

STEPHEN LIGAMBI
Senior Associate
212.468.5985
sligambi@meridiancapital.com

SHAYA KATZ
Associate
212.468.5991
shaya.katz@meridiancapital.com



MERIDIAN
RETAIL LEASING

All information supplied is from sources deemed reliable and is furnished subject to errors, omissions, modifications, removal of the listing from sale or lease, and to any listing conditions, including the rates and manner of payment of commissions for particular offerings imposed by Meridian Capital Group. This information may include estimates and projections prepared by Meridian Capital Group with respect to future events, and these future events may or may not actually occur. Such estimates and projections reflect various assumptions concerning anticipated results. While Meridian Capital Group believes these assumptions are reasonable, there can be no assurance that any of these estimates and projections will be correct. Therefore, actual results may vary materially from these estimates and projections. Any square footage dimensions set forth are approximate.

305 EAST FORDHAM ROAD

FORDHAM, BRONX | Corner of East Fordham and East Kingsbridge Roads

RETAIL FOR LEASE

NEIGHBORS



NOAM AZIZ

Senior Director
212.468.5984
naziz@meridiancapital.com

STEPHEN LIGAMBI

Senior Associate
212.468.5985
sligambi@meridiancapital.com

SHAYA KATZ

Associate
212.468.5991
shaya.katz@meridiancapital.com



MERIDIAN
RETAIL LEASING

All information supplied is from sources deemed reliable and is furnished subject to errors, omissions, modifications, removal of the listing from sale or lease, and to any listing conditions, including the rates and manner of payment of commissions for particular offerings imposed by Meridian Capital Group. This information may include estimates and projections prepared by Meridian Capital Group with respect to future events, and these future events may or may not actually occur. Such estimates and projections reflect various assumptions concerning anticipated results. While Meridian Capital Group believes these assumptions are reasonable, there can be no assurance that any of these estimates and projections will be correct. Therefore, actual results may vary materially from these estimates and projections. Any square footage dimensions set forth are approximate.