

1939-47

NORTH FRONT STREET

FISHTOWN, PHILADELPHIA

Between West Norris & Berks Streets

RETAIL FOR LEASE



PROPERTY INFORMATION

APPROXIMATE SIZE

10,000 SF

POSSIBLE DIVISIONS

Option A: 10,000 (Indoors)

Option B: 6,500 SF + 3,500 SF (Outdoors)

ASKING RENT

\$42,000/Month

POSSESSION

Immediate

TERM

10-15 Years

FRONTAGE

40 FT

COMMENTS

- Large open retail space
- Previously "Liberty Choice Grocery Store"
- 20 FT ceilings throughout
- Massive outdoor space can be made available

NEIGHBORS

The Isaac • Star Bolt • Education Nation • Burning Spirits Boxing • J.A. Cunningham • Weldsale • Rosalinda Beauty Salon • Hope Street Apartments

TRANSPORTATION



JAMES FAMULARO

President
646.658.7373
jfamularo@meridiancapital.com

JACOB MAYER

Director
212.468.5926
jmayer@meridiancapital.com

COLE KLEPPINGER

Associate
212.468.5993
ckleppinger@meridiancapital.com

ASHLYN LORENTZ

Associate
212.468.5954
alorentz@meridiancapital.com



All information supplied is from sources deemed reliable and is furnished subject to errors, omissions, modifications, removal of the listing from sale or lease, and to any listing conditions, including the rates and manner of payment of commissions for particular offerings imposed by Meridian Capital Group. This information may include estimates and projections prepared by Meridian Capital Group with respect to future events, and these future events may or may not actually occur. Such estimates and projections reflect various assumptions concerning anticipated results. While Meridian Capital Group believes these assumptions are reasonable, there can be no assurance that any of these estimates and projections will be correct. Therefore, actual results may vary materially from these estimates and projections. Any square footage dimensions set forth are approximate.

1939-47 NORTH FRONT STREET

FISHTOWN, PHILADELPHIA | Between West Norris and Berks Streets

RETAIL FOR LEASE



INTERIOR

JAMES FAMULARO

President
646.658.7373
jfamularo@meridiancapital.com

JACOB MAYER

Director
212.468.5926
jmayer@meridiancapital.com

COLE KLEPPINGER

Associate
212.468.5993
ckleppinger@meridiancapital.com

ASHLYN LORENTZ

Associate
212.468.5954
alorentz@meridiancapital.com



All information supplied is from sources deemed reliable and is furnished subject to errors, omissions, modifications, removal of the listing from sale or lease, and to any listing conditions, including the rates and manner of payment of commissions for particular offerings imposed by Meridian Capital Group. This information may include estimates and projections prepared by Meridian Capital Group with respect to future events, and these future events may or may not actually occur. Such estimates and projections reflect various assumptions concerning anticipated results. While Meridian Capital Group believes these assumptions are reasonable, there can be no assurance that any of these estimates and projections will be correct. Therefore, actual results may vary materially from these estimates and projections. Any square footage dimensions set forth are approximate.



JAMES FAMULARO

President
646.658.7373
jfamularo@meridiancapital.com

JACOB MAYER

Director
212.468.5926
jmayer@meridiancapital.com

COLE KLEPPINGER

Associate
212.468.5993
ckleppinger@meridiancapital.com

ASHLYN LORENTZ

Associate
212.468.5954
alorentz@meridiancapital.com



MERIDIAN
RETAIL LEASING

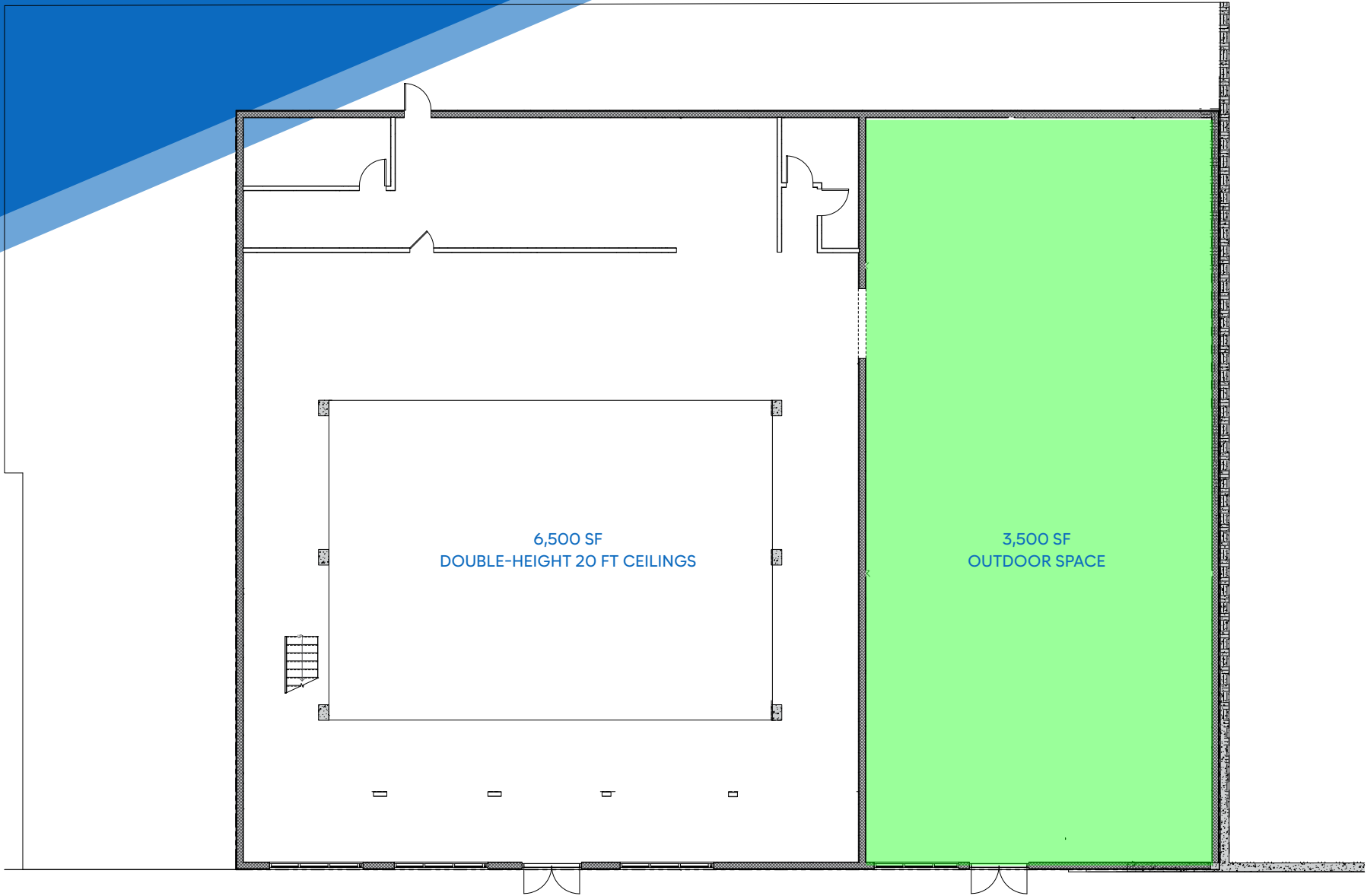

JAMES FAMULARO

President
646.658.7373
jfamularo@meridiancapital.com

JACOB MAYER

Director
212.468.5926
jmayer@meridiancapital.com

COLE KLEPPINGER

Associate
212.468.5993
ckleppinger@meridiancapital.com

ASHLYN LORENTZ

Associate
212.468.5954
alorentz@meridiancapital.com



1939-47 NORTH FRONT STREET

FISHTOWN, PHILADELPHIA | Between West Norris and Berks Streets

RETAIL FOR LEASE

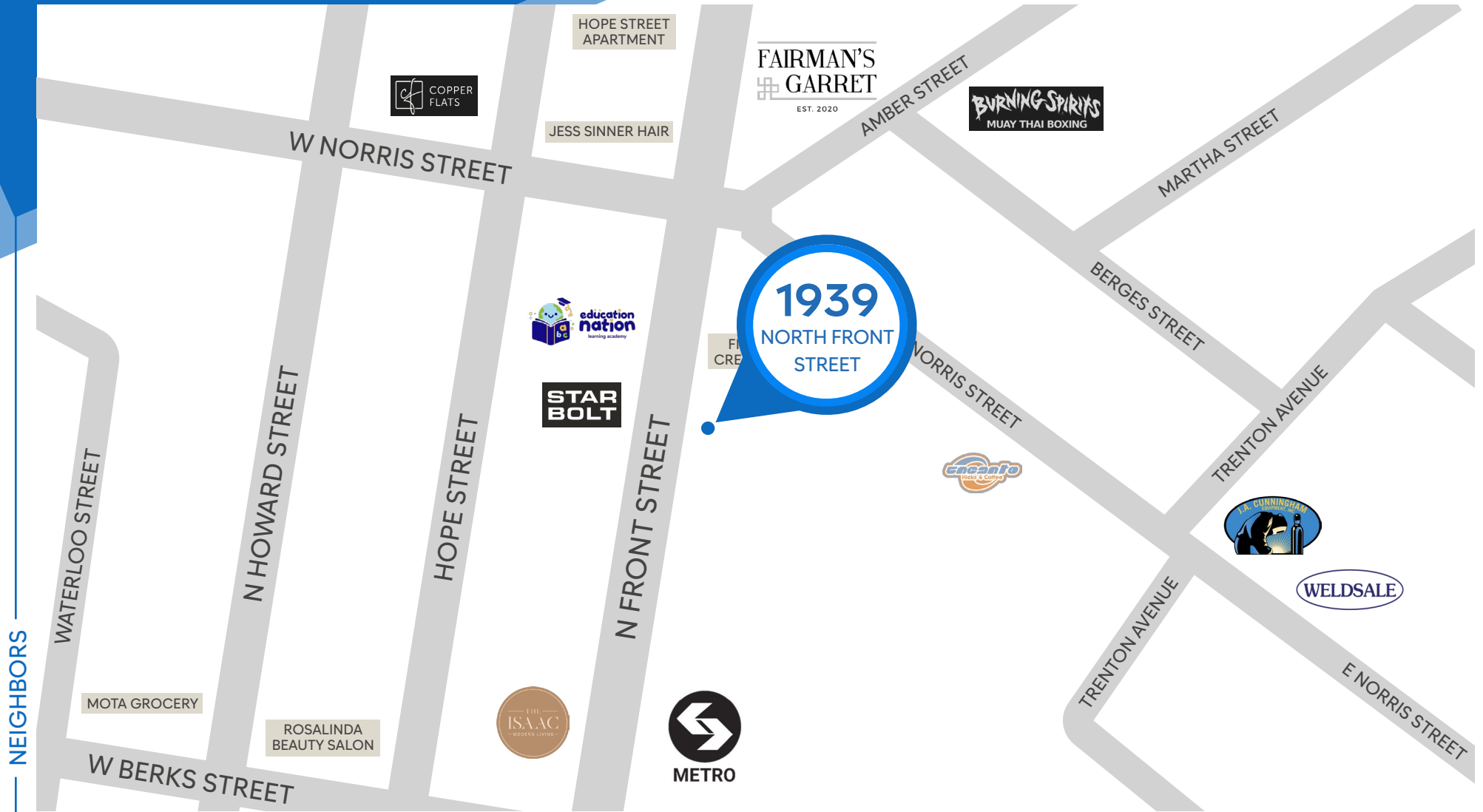

NEIGHBORS

JAMES FAMULARO

President
646.658.7373
jfamularo@meridiancapital.com

JACOB MAYER

Director
212.468.5926
jmayer@meridiancapital.com

COLE KLEPPINGER

Associate
212.468.5993
ckleppinger@meridiancapital.com

ASHLYN LORENTZ

Associate
212.468.5954
alorentz@meridiancapital.com



All information supplied is from sources deemed reliable and is furnished subject to errors, omissions, modifications, removal of the listing from sale or lease, and to any listing conditions, including the rates and manner of payment of commissions for particular offerings imposed by Meridian Capital Group. This information may include estimates and projections prepared by Meridian Capital Group with respect to future events, and these future events may or may not actually occur. Such estimates and projections reflect various assumptions concerning anticipated results. While Meridian Capital Group believes these assumptions are reasonable, there can be no assurance that any of these estimates and projections will be correct. Therefore, actual results may vary materially from these estimates and projections. Any square footage dimensions set forth are approximate.