

EXCLUSIVE 2606 BROADWAY RETAIL CONDOMINIUM NEW YORK, NY 10025



Available Retail

PETQU
N.Y. AQUATIC & PET
SALES INSTALLATION MAINTENANCE
312-860-7500

99¢
99¢ PLANET OR MORE
COSMETIC HOUSEWARE BEAUTY SUPPLIES
PARTY STUFF & STATIONARY
TEL. 212-531-3017

DUNKIN' BROS. BASKIN-ROBBINS

 **MERIDIAN**
INVESTMENT SALES

EXCLUSIVE

2606 BROADWAY, NEW YORK, NY 10025

AKA 215 WEST 98TH STREET | MANHATTAN VALLEY | RETAIL CONDO | 1,811 SF

ASKING PRICE:

~~\$2,250,000~~ \$1,450,000

RETAIL CONDO | GROUND FLOOR & BASEMENT

This retail condominium is one of six retail units located on the ground floor at The Gramont, a 96-unit, 173,686 SF pre-war residential condominium building. The opportunity presented is one retail unit that will be delivered vacant with 800 SF of ground floor space and 1,011 SF of basement space. The other retail tenants in the building include Dunkin Donuts/Baskin Robbins, 99 Cent Planet, Petqua (pet store), and NY Smiles Dental. Manhattan Valley, which is the northern part of the Upper West Side, is a charming neighborhood characterized by its sloping streets and eclectic mix of buildings. The area features pre-war apartment buildings, classic New York brownstones, and modern developments such as Columbus Square. Known for its strong sense of community, rich history, and proximity to Central Park and Riverside Park, Manhattan Valley offers a tranquil yet vibrant urban living experience. The Property is conveniently located just two blocks north of the West 96th Street / Broadway [1, 2 & 3] Trains.

PROPERTY INFORMATION

ADDRESS	2606 Broadway
BLOCK / LOT	1870 / 1104
PROPERTY TYPE	Retail Condominium
MARKET (SUBMARKET)	Manhattan (Manhattan Valley)
LOCATION DESCRIPTION	NE Corner Broadway & NE 98 th St
BUILDING LOT AREA	19,710 SF
RETAIL CONDO LOT AREA	760 SF
BUILDING DIMENSIONS	100.92' x 202.35' (IRR)
RETAIL CONDO DIMENSIONS	19' x 40' (Ground Floor)
YEAR BUILT	1911
ZONING	R9A, R8B, C1-5, EC-3

EXPENSES

EXPENSES	
REAL ESTATE TAXES (2025/2026)	\$34,000
CAM (\$1500 / MO)	\$18,000
TOTAL EXPENSES	\$52,000

PRICING METRICS

PRICE	\$1,450,000
-------	-------------

INVESTMENT HIGHLIGHTS

- 

Use Group 6 Retail and service establishments that serve local shopping needs, such as food and small clothing stores, beauty parlors, and dry cleaners.
- 

Prime Retail Corridor Highly trafficked corridor on Broadway with an abundance of retail stores and restaurants
- 

End User Deal Opportunity for an end user to own and occupy a space to operate their business in a busy neighborhood close to major transportation.



EXCLUSIVE 2606 BROADWAY, NEW YORK, NY 10025

AKA 215 WEST 98TH STREET | MANHATTAN VALLEY | RETAIL CONDO | 1,811 SF

PROPERTY PHOTOS - RETAIL CONDO INTERIOR

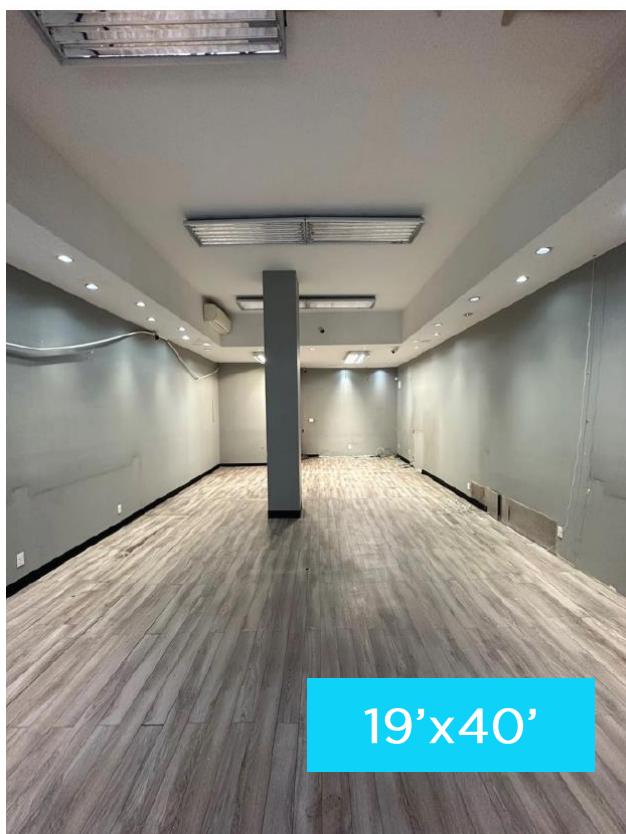

EXCLUSIVE 2606 BROADWAY, NEW YORK, NY 10025

AKA 215 WEST 98TH STREET | MANHATTAN VALLEY | RETAIL CONDO | 1,811 SF

PROPERTY PHOTO - RETAIL CONDO FLOORPLANS

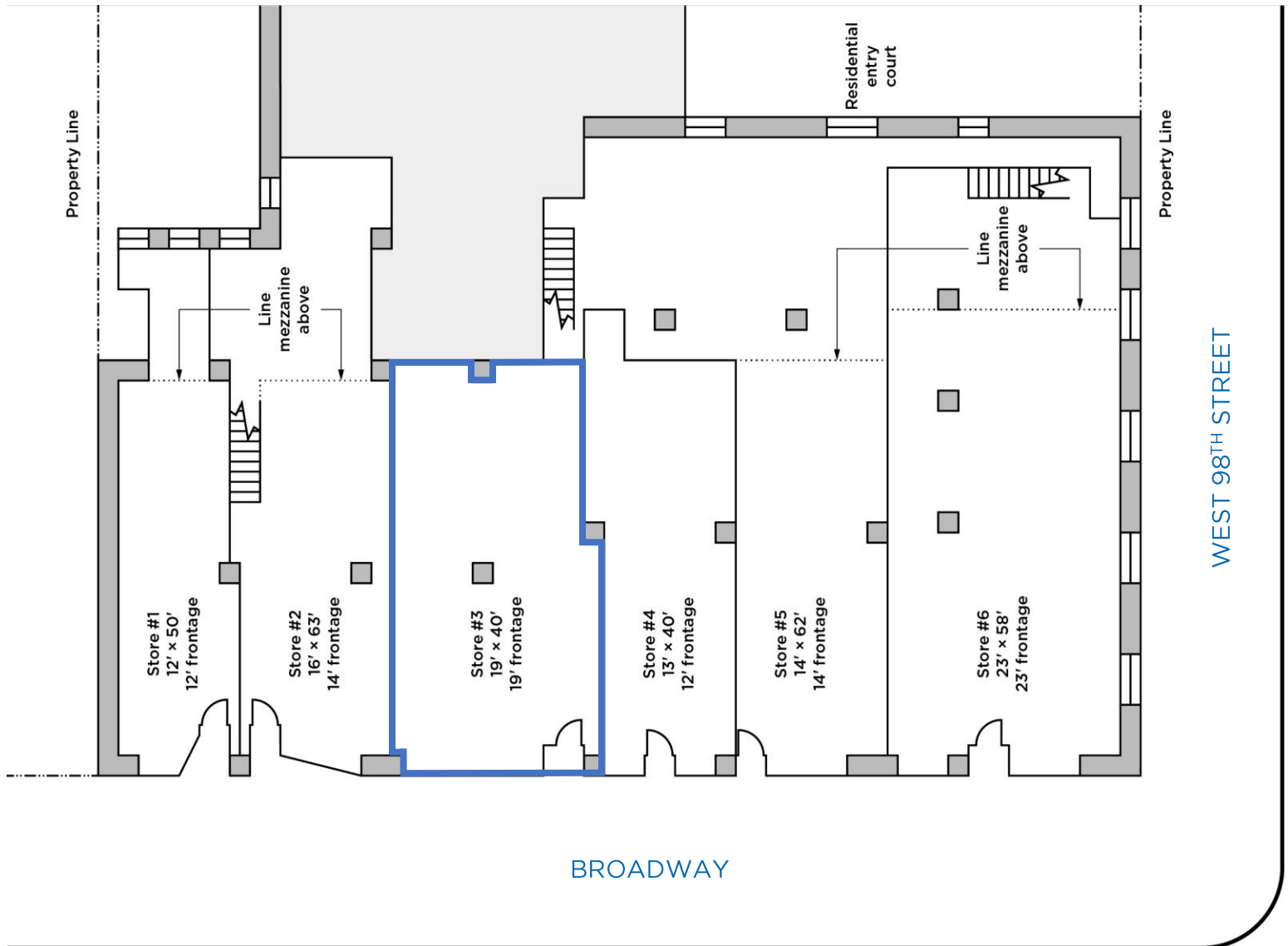

NOTABLE NEARBY RETAIL ON BROADWAY



EXCLUSIVE

2606 BROADWAY, NEW YORK, NY 10025

AKA 215 WEST 98TH STREET | MANHATTAN VALLEY | RETAIL CONDO | 1,811 SF

PROPERTY PHOTO - AERIAL

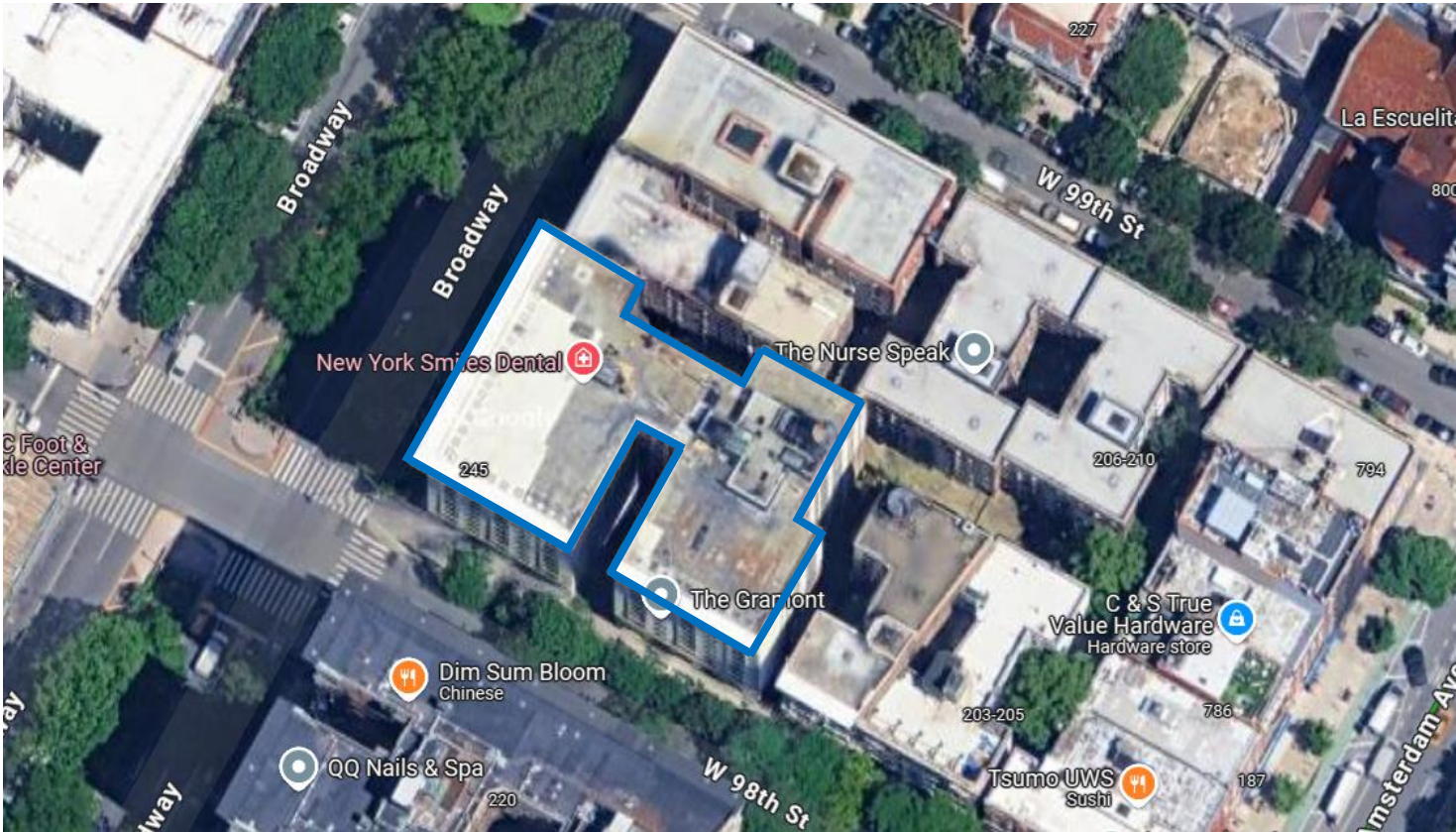

EXCLUSIVE
2606 BROADWAY, NEW YORK, NY 10025
AKA 215 WEST 98TH STREET | MANHATTAN VALLEY | RETAIL CONDO | 1,811 SF

PROPERTY PHOTOS



EXCLUSIVE
2606 BROADWAY, NEW YORK, NY 10025
AKA 215 WEST 98TH STREET | MANHATTAN VALLEY | RETAIL CONDO | 1,811 SF

PROPERTY PHOTOS



EXCLUSIVE

2606 BROADWAY, NEW YORK, NY 10025

AKA 215 WEST 98TH STREET | MANHATTAN VALLEY | RETAIL CONDO | 1,811 SF

PLOT & NEIGHBORHOOD MAPS

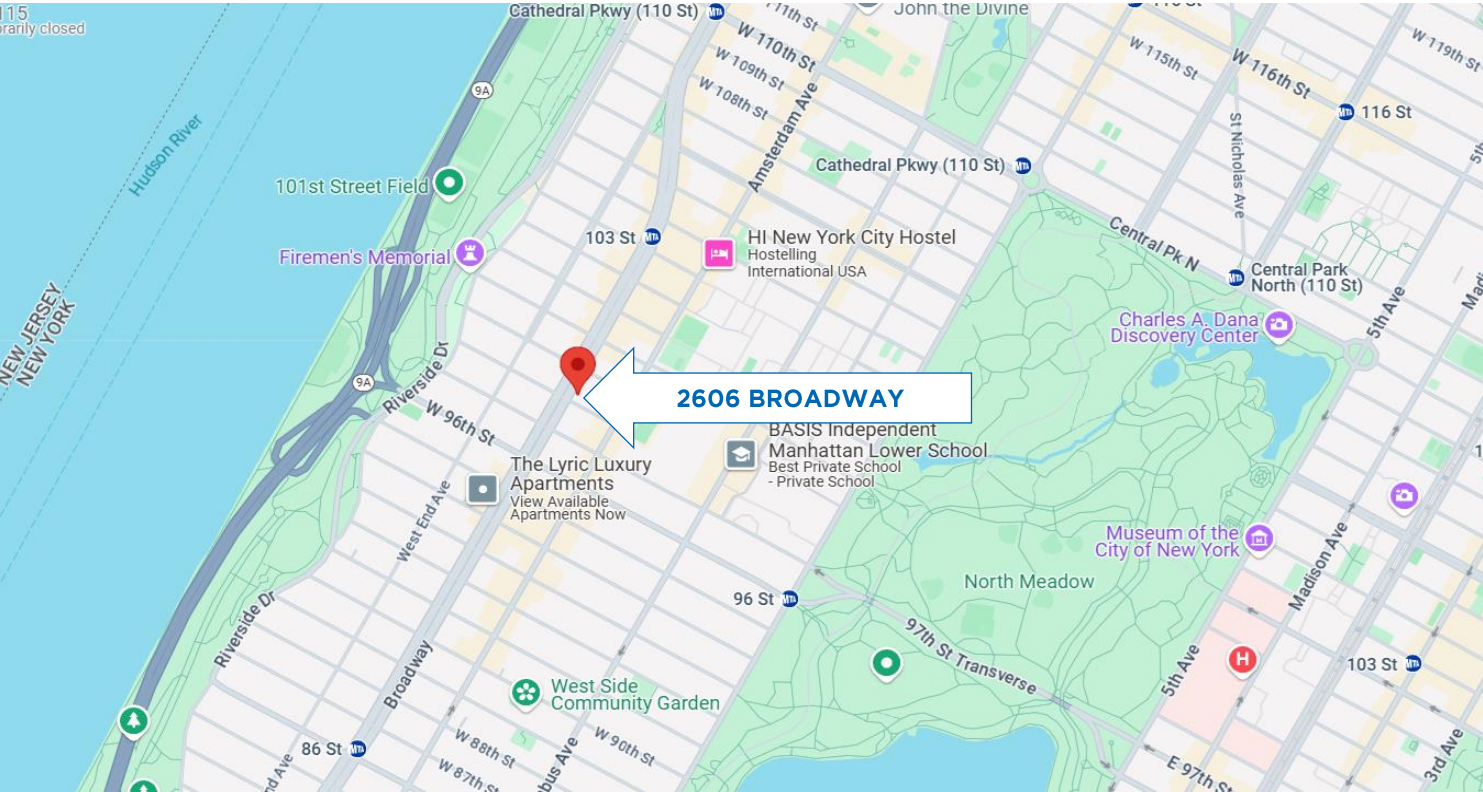

EXCLUSIVE 2606 BROADWAY RETAIL CONDOMINIUM

MANHATTAN VALLEY, NY 10025

PLEASE CONTACT:

AMIT DOSHI

SENIOR EXECUTIVE MANAGING DIRECTOR

212.468.5959

adoshi@meridiancapital.com

SHALLINI MEHRA

MANAGING DIRECTOR

212.462.5958

smehra@meridiancapital.com

CHIRAG DOSHI

VICE PRESIDENT

212.612.0257

cdoshi@meridiancapital.com

LUKE RIZZO

ASSOCIATE

212.468.5967

lrizzo@meridiancapital.com

RYAN DELMONTE

SENIOR ANALYST

212.468.5943

rdelmonte@meridiancapital.com

HANNAH GRANOT

MARKETING ANALYST

212.468.5916

hgranot@meridiancapital.com

NOAM AZIZ

DIRECTOR - RETAIL LEASING

212.468.5984

naziz@meridiancapital.com

IMPORTANT LEGAL DISCLAIMER

This is a confidential document intended solely for your limited use and benefit in determining whether you desire to express any further interest in the proposed sale of the real property (or interests therein) described herein (the "Property"). This document contains selected information pertaining to the Property and does not purport to be all-inclusive or to contain all of the information that a prospective purchaser, mortgagee, investor, lender, or lessee may desire. Neither Owner, Meridian Capital Group, LLC ("MCG") nor any of their respective officers, directors, partners, agents, brokers or employees have made any representation or warranty, expressed or implied, as to the accuracy or completeness of this document or any of its contents, and no legal commitments or obligations shall arise by reason of this document or any of its contents. Unless specifically agreed to by MCG in writing to the contrary, MCG will not share its commission earned in connection with the Property with any broker, finder or agent.