

# 479

## WASHINGTON STREET

HUDSON SQUARE, NYC

Between Canal & Spring Streets

RETAIL FOR LEASE

### APPROXIMATE SIZE

Ground Floor: 1,200 SF

### ASKING RENT

\$7,000/Month

### POSSESSION

Immediate

### TERM

5+ Years

### COMMENTS

- Newly redeveloped luxury residential building
- Space to be delivered in clean white-box condition
- Perfect for any retail/office-flex user
- Extra storage/basement space available
- ADA compliant lift in place

### NEIGHBORS

Ear Inn • Houseman • Lazy Point • Paul's Baby Grand • Hotel Hugo • Adoro Lei • Peachy • Solidcore • Arlo SoHo • Phillip Lim • Pine & Polk • La Sirène

### TRANSPORTATION



### JAMES FAMULARO

President

### GARRETT KELLY

Director

212.468.5939

gkelly@meridiancapital.com

### NOAM AZIZ

Director

212.468.5984

naziz@meridiancapital.com

### MAX FREUDENBERGER

Associate

212.468.5951

mfreudenberg@meridiancapital.com



**MERIDIAN**  
RETAIL LEASING

All information supplied is from sources deemed reliable and is furnished subject to errors, omissions, modifications, removal of the listing from sale or lease, and to any listing conditions, including the rates and manner of payment of commissions for particular offerings imposed by Meridian Capital Group. This information may include estimates and projections prepared by Meridian Capital Group with respect to future events, and these future events may or may not actually occur. Such estimates and projections reflect various assumptions concerning anticipated results. While Meridian Capital Group believes these assumptions are reasonable, there can be no assurance that any of these estimates and projections will be correct. Therefore, actual results may vary materially from these estimates and projections. Any square footage dimensions set forth are approximate.

479 WASHINGTON STREET  
HUDSON SQUARE, NYC | Between Canal and Spring Streets

RETAIL FOR LEASE

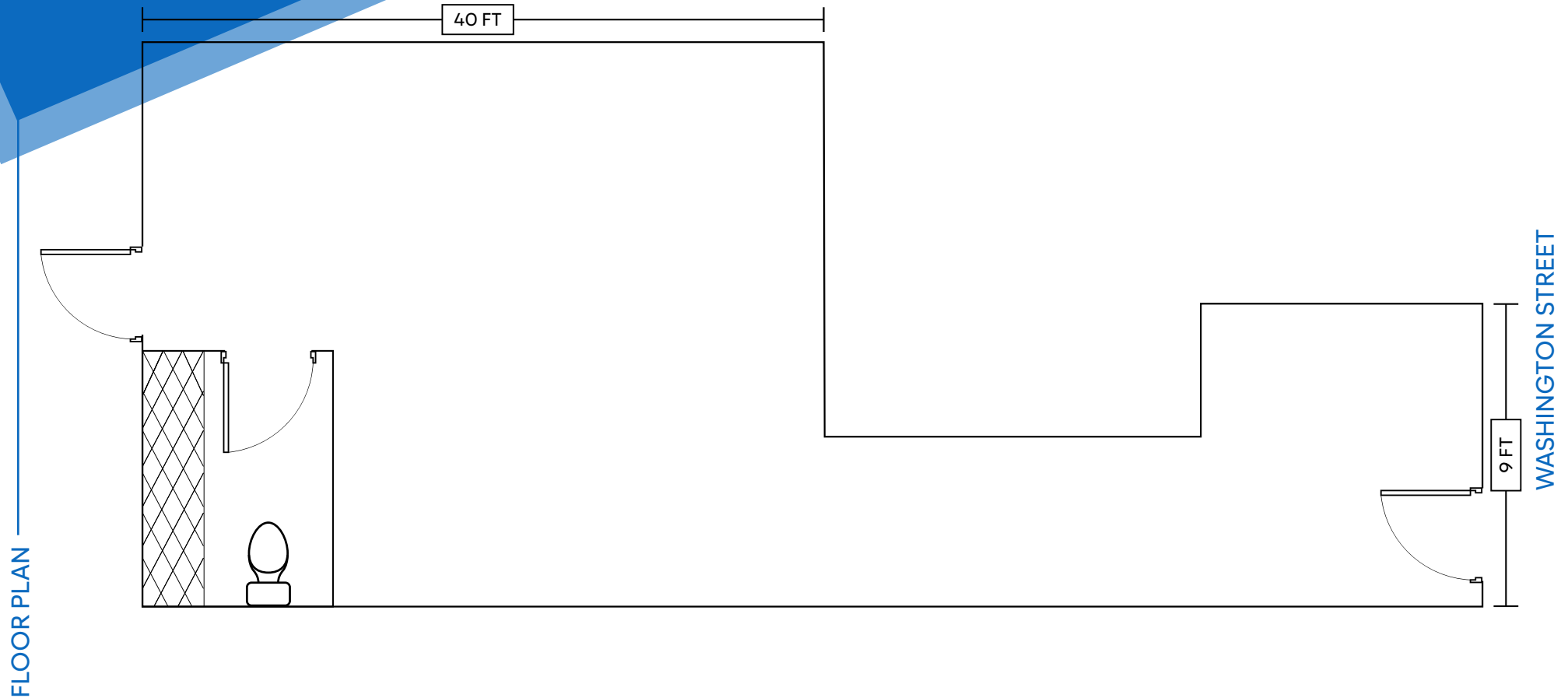

JAMES FAMULARO  
President

GARRETT KELLY  
Director  
212.468.5939  
gkelly@meridiancapital.com

NOAM AZIZ  
Director  
212.468.5984  
naziz@meridiancapital.com

MAX FREUDENBERGER  
Associate  
212.468.5951  
mfreudenberg@meridiancapital.com



**MERIDIAN**  
RETAIL LEASING

All information supplied is from sources deemed reliable and is furnished subject to errors, omissions, modifications, removal of the listing from sale or lease, and to any listing conditions, including the rates and manner of payment of commissions for particular offerings imposed by Meridian Capital Group. This information may include estimates and projections prepared by Meridian Capital Group with respect to future events, and these future events may or may not actually occur. Such estimates and projections reflect various assumptions concerning anticipated results. While Meridian Capital Group believes these assumptions are reasonable, there can be no assurance that any of these estimates and projections will be correct. Therefore, actual results may vary materially from these estimates and projections. Any square footage dimensions set forth are approximate.



# 479 WASHINGTON STREET

HUDSON SQUARE, NYC | Between Canal and Spring Streets

RETAIL FOR LEASE

NEIGHBORS

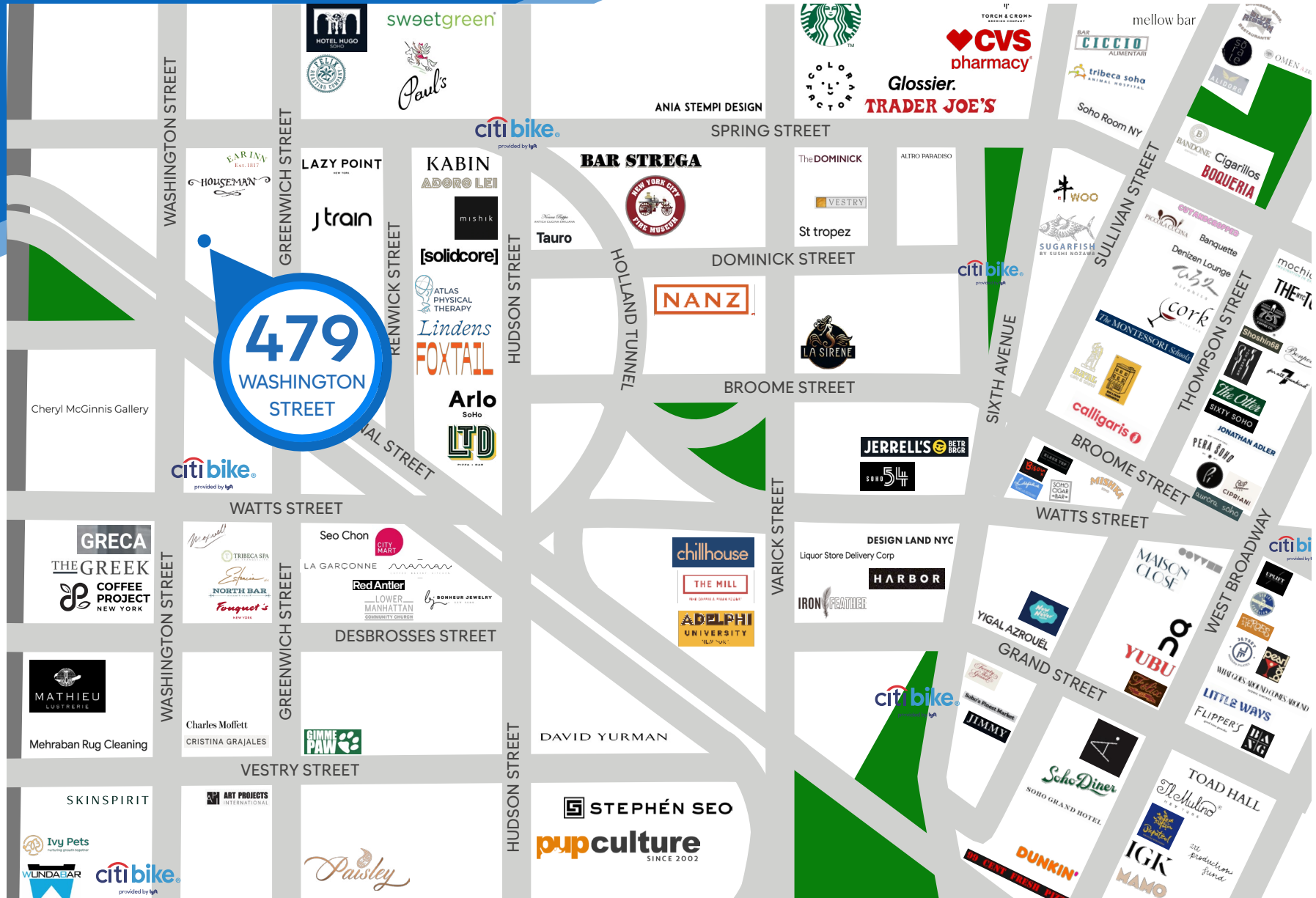

**JAMES FAMULARO**  
President

**GARRETT KELLY**  
Director  
212.468.5939  
gkelly@meridiancapital.com

**NOAM AZIZ**  
Director  
212.468.5984  
naziz@meridiancapital.com

**MAX FREUDENBERGER**  
Associate  
212.468.5951  
mfreudenberg@meridiancapital.com



**MERIDIAN**  
RETAIL LEASING

All information supplied is from sources deemed reliable and is furnished subject to errors, omissions, modifications, removal of the listing from sale or lease, and to any listing conditions, including the rates and manner of payment of commissions for particular offerings imposed by Meridian Capital Group. This information may include estimates and projections prepared by Meridian Capital Group with respect to future events, and these future events may or may not actually occur. Such estimates and projections reflect various assumptions concerning anticipated results. While Meridian Capital Group believes these assumptions are reasonable, there can be no assurance that any of these estimates and projections will be correct. Therefore, actual results may vary materially from these estimates and projections. Any square footage dimensions set forth are approximate.