

# 161

## ORCHARD STREET LOWER EAST SIDE, NYC

Between Stanton & Rivington Streets

RETAIL FOR LEASE

### APPROXIMATE SIZE

1,300 SF + Basement

### ASKING RENT

\$8,500/Month

### POSSESSION

Immediate

### TERM

10-15 Years

### FRONTAGE

12 FT on Orchard Street  
12 FT on Allen Street

### COMMENTS

- Unique block-through retail opportunity in the heart of the Lower East Side
- Logical divisions considered
- Rectangular column-free space
- Prime retail corridor with strong co-tenancy
- 7-day-a-week foot traffic

### NEIGHBORS

Johnny's Pizza • 7<sup>th</sup> Street Burger • Insomnia Cookies • Pardon Me • Saigon Social • Tres Leches • Viva Birria • Pianos • Kind Regards • Dirty French • Ms Yoo • Sauce • Van Leeuwen • Sweet Chick • Russ & Daughters • Bar Goto • Katz's Delicatessen

### TRANSPORTATION



PROPERTY INFORMATION

### JAMES FAMULARO

President  
646.658.7373  
jfamularo@meridiancapital.com

### COLE KLEPPINGER

Associate  
212.468.5993  
ckleppinger@meridiancapital.com



**MERIDIAN**  
RETAIL LEASING

All information supplied is from sources deemed reliable and is furnished subject to errors, omissions, modifications, removal of the listing from sale or lease, and to any listing conditions, including the rates and manner of payment of commissions for particular offerings imposed by Meridian Capital Group. This information may include estimates and projections prepared by Meridian Capital Group with respect to future events, and these future events may or may not actually occur. Such estimates and projections reflect various assumptions concerning anticipated results. While Meridian Capital Group believes these assumptions are reasonable, there can be no assurance that any of these estimates and projections will be correct. Therefore, actual results may vary materially from these estimates and projections. Any square footage dimensions set forth are approximate.

FLOOR PLAN

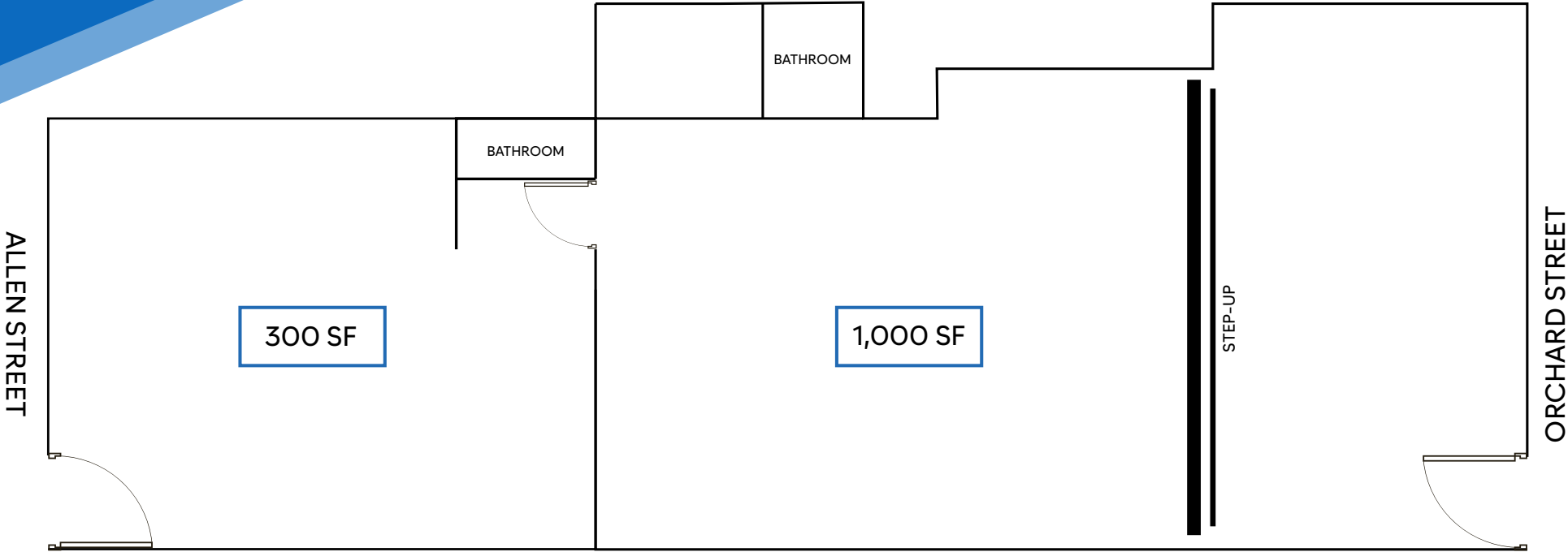

JAMES FAMULARO

President  
646.658.7373  
jfamularo@meridiancapital.com

COLE KLEPPINGER

Associate  
212.468.5993  
ckleppinger@meridiancapital.com



MERIDIAN  
RETAIL LEASING

All information supplied is from sources deemed reliable and is furnished subject to errors, omissions, modifications, removal of the listing from sale or lease, and to any listing conditions, including the rates and manner of payment of commissions for particular offerings imposed by Meridian Capital Group. This information may include estimates and projections prepared by Meridian Capital Group with respect to future events, and these future events may or may not actually occur. Such estimates and projections reflect various assumptions concerning anticipated results. While Meridian Capital Group believes these assumptions are reasonable, there can be no assurance that any of these estimates and projections will be correct. Therefore, actual results may vary materially from these estimates and projections. Any square footage dimensions set forth are approximate.

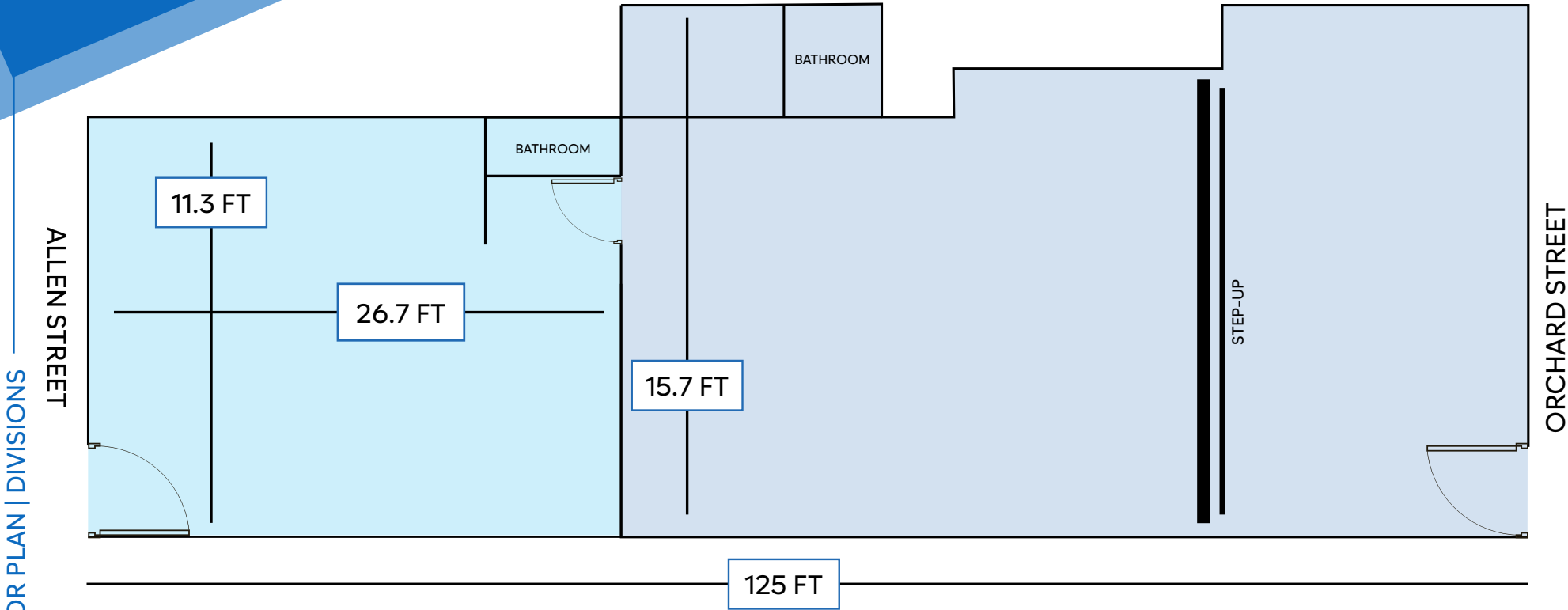

JAMES FAMULARO  
President  
646.658.7373  
jfamularo@meridiancapital.com

COLE KLEPPINGER  
Associate  
212.468.5993  
ckleppinger@meridiancapital.com



MERIDIAN  
RETAIL LEASING

All information supplied is from sources deemed reliable and is furnished subject to errors, omissions, modifications, removal of the listing from sale or lease, and to any listing conditions, including the rates and manner of payment of commissions for particular offerings imposed by Meridian Capital Group. This information may include estimates and projections prepared by Meridian Capital Group with respect to future events, and these future events may or may not actually occur. Such estimates and projections reflect various assumptions concerning anticipated results. While Meridian Capital Group believes these assumptions are reasonable, there can be no assurance that any of these estimates and projections will be correct. Therefore, actual results may vary materially from these estimates and projections. Any square footage dimensions set forth are approximate.





JAMES FAMULARO

President  
646.658.7373  
jfamularo@meridiancapital.com

COLE KLEPPINGER

Associate  
212.468.5993  
ckleppinger@meridiancapital.com



**MERIDIAN**  
RETAIL LEASING