

# 149

## CHURCH STREET

TRIBECA, NYC

Between Corner of Church & Warren Streets

RETAIL/RESTAURANT FOR LEASE

### APPROXIMATE SIZE

Ground Floor: 2,208 SF

### ASKING RENT

Upon Request

### POSSESSION

Immediate

### TERM

Negotiable

### FRONTAGE

80 FT Wraparound

### COMMENTS

- Highly visible tribeca corner in a prime location
- Brand-new wraparound windows
- Black-iron venting in place
- Private bathroom
- Close proximity to subway hubs
- All uses considered

### NEIGHBORS

- Isomnia Cookies • Blank Street • Birch Coffee  
• Artesano • European Wax Center • Equinox  
• Boss Tweeds • Lenwich • Tribeca Social

### TRANSPORTATION

1 2 3 R W 4 5 6 A C E



PROPERTY INFORMATION

JAMES FAMULARO

President

NOAM AZIZ

Director  
212.468.5984  
naziz@meridiancapital.com

CARSON SHAHRABANI

Associate  
212.468.5927  
cshahrabani@meridiancapital.com



**MERIDIAN**  
RETAIL LEASING

All information supplied is from sources deemed reliable and is furnished subject to errors, omissions, modifications, removal of the listing from sale or lease, and to any listing conditions, including the rates and manner of payment of commissions for particular offerings imposed by Meridian Capital Group. This information may include estimates and projections prepared by Meridian Capital Group with respect to future events, and these future events may or may not actually occur. Such estimates and projections reflect various assumptions concerning anticipated results. While Meridian Capital Group believes these assumptions are reasonable, there can be no assurance that any of these estimates and projections will be correct. Therefore, actual results may vary materially from these estimates and projections. Any square footage dimensions set forth are approximate.



# 149 CHURCH STREET

TRIBECA, NYC | Corner of Church and Warren Streets

RETAIL/RESTAURANT FOR LEASE



INTERIOR

**JAMES FAMULARO**  
President

**NOAM AZIZ**  
Director  
212.468.5984  
naziz@meridiancapital.com

**CARSON SHAHRABANI**  
Associate  
212.468.5927  
cshahrabani@meridiancapital.com



**MERIDIAN**  
RETAIL LEASING

All information supplied is from sources deemed reliable and is furnished subject to errors, omissions, modifications, removal of the listing from sale or lease, and to any listing conditions, including the rates and manner of payment of commissions for particular offerings imposed by Meridian Capital Group. This information may include estimates and projections prepared by Meridian Capital Group with respect to future events, and these future events may or may not actually occur. Such estimates and projections reflect various assumptions concerning anticipated results. While Meridian Capital Group believes these assumptions are reasonable, there can be no assurance that any of these estimates and projections will be correct. Therefore, actual results may vary materially from these estimates and projections. Any square footage dimensions set forth are approximate.

# 149 CHURCH STREET

TRIBECA, NYC | Corner of Church and Warren Streets

RETAIL/RESTAURANT FOR LEASE

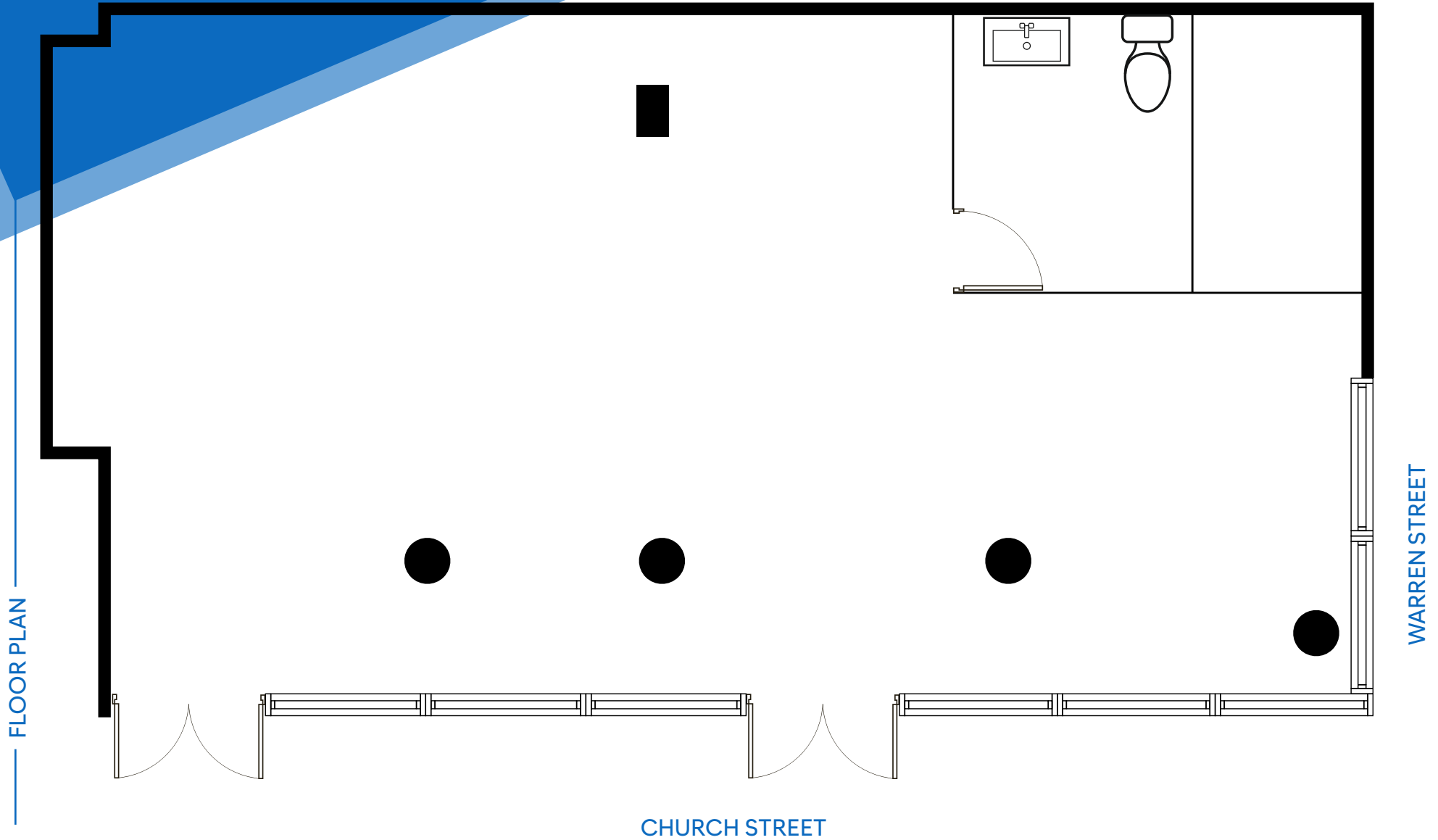

**JAMES FAMULARO**  
President

**NOAM AZIZ**  
Director  
212.468.5984  
naziz@meridiancapital.com

**CARSON SHAHRABANI**  
Associate  
212.468.5927  
cshahrabani@meridiancapital.com



**MERIDIAN**  
RETAIL LEASING

All information supplied is from sources deemed reliable and is furnished subject to errors, omissions, modifications, removal of the listing from sale or lease, and to any listing conditions, including the rates and manner of payment of commissions for particular offerings imposed by Meridian Capital Group. This information may include estimates and projections prepared by Meridian Capital Group with respect to future events, and these future events may or may not actually occur. Such estimates and projections reflect various assumptions concerning anticipated results. While Meridian Capital Group believes these assumptions are reasonable, there can be no assurance that any of these estimates and projections will be correct. Therefore, actual results may vary materially from these estimates and projections. Any square footage dimensions set forth are approximate.

149 CHURCH STREET

TRIBECA, NYC | Corner of Church and Warren Streets

RETAIL/RESTAURANT FOR LEASE

NEIGHBORS

**READE STREET**

- Little More
- MAYWEATHER BOXING-FITNESS
- Tribeca Cleaners
- GREENWICH ST JEWELERS since 1976
- PALETTE NAILS STUDIO
- Unique Shape Threading Salon Inc
- City Hall Wines & Spirits
- Cozy Cuts And Nails
- Chun Yang Tea Tribeca
- Little Italy Pizza
- HUNGRY GHOST COFFEE
- V.I.P NAIL
- Sala's Bagel & Brunch
- Veelph
- TAVERN ON READE
- ID Bank America's Most Convenient Bank
- LOT LESS
- The Smello
- New Fresco Tortillas
- CHIPOTLE MEXICAN GRILL
- Subway
- EUROPEAN WAX CENTER
- Nelly's Boutique
- CITYMD
- B&H Jewelry
- Maria's Alterations
- citi bike provided by IGH
- POTBELLY SANDWICH SHOP
- NYC Buildings

**CHAMBERS STREET**

- HAL BROMM
- Bouley
- The Daily Grocer
- ian-American School Manhattan
- GALERIE-BAR
- MUDVILLE
- POSTER MUSEUM
- HECTOR'S JEWELRY
- China Red Gourmet
- Smyth TRIBECA
- SK7 SOLUTIONS COLLECTIVE
- BABESTA TRIBECA
- LE PAIN QUOTIDIEN
- The Mysterious Bookshop
- CVS pharmacy
- DUNKIN'
- 100 Chambers Ice Cream
- Downtown News
- 149 CHURCH STREET
- DE JANEIRO
- KULA YOGA PROJECT
- icca JAPANESE RESTAURANT
- Fountain Pen Hospital
- BANK OF AMERICA
- Bidjar Rug Care
- NY Shade Design

**WARREN STREET**

- OLD DAYS FARM TO TABLE
- Cloud Gallery
- alts
- Della's
- FranklyWines
- Corner Gourmet
- GUNBAE
- KORIN since 1982
- AL MAADAN
- Expert Dental N.Y.C.
- LOS TACOS NYC
- Birch Coffee
- Sufu Nail Spa
- LASHLOVE
- CLUB PILATES
- DUNKIN'
- Nail SPY
- Benares INDIAN RESTAURANT
- Boss Tweeds
- MOVING VISIONS DANCE
- BLANK STREET
- Affina BEAUTY & SPA
- TriBeCa Dental Associates
- Takahachi
- NYC Buildings
- CHASE

**MURRAY STREET**

- Here. Go Anywhere. ATLAN COMMUNITY COLLEGE
- earthbar
- EQUINOX FITNESS CLUBS
- Starbucks
- NOFAR METHOD
- LEN-WICH
- Cloud Water.
- ISS
- TRIBECA SOCIAL

JAMES FAMULARO  
President

NOAM AZIZ  
Director  
212.468.5984  
naziz@meridiancapital.com

CARSON SHAHRABANI  
Associate  
212.468.5927  
cshahrabani@meridiancapital.com



**MERIDIAN**  
RETAIL LEASING

All information supplied is from sources deemed reliable and is furnished subject to errors, omissions, modifications, removal of the listing from sale or lease, and to any listing conditions, including the rates and manner of payment of commissions for particular offerings imposed by Meridian Capital Group. This information may include estimates and projections prepared by Meridian Capital Group with respect to future events, and these future events may or may not actually occur. Such estimates and projections reflect various assumptions concerning anticipated results. While Meridian Capital Group believes these assumptions are reasonable, there can be no assurance that any of these estimates and projections will be correct. Therefore, actual results may vary materially from these estimates and projections. Any square footage dimensions set forth are approximate.