

114

WEST 27TH STREET CHELSEA, NYC

Between Sixth & Seventh Avenues

RETAIL FOR LEASE

APPROXIMATE SIZE

Ground Floor: 3,000 SF
Lower Level: 1,800 SF

ASKING RENT

~~\$29,900/Month~~ Reduced
\$19,999/Month

POSSESSION

Immediate

TERM

5-15 Years

FRONTAGE

30 FT

COMMENTS

- Large retail space in white-box condition
- Strong co-tenancy surrounding
- Steps from the vibrant and trendy area of NoMad District, Ritz Carlton, FIT, and Equinox
- Can be vented

NEIGHBORS

Ritz Carlton Hotel • Ininside by Meliá • Equinox
• Planet Fitness • Soulcycle • Starbucks •
Patent Pending • Oscar Wilde • Anita Gelato
• FIT • Moxy Hotel • Swingers • Friedmans
• Crompton Ale House • Sid Gold's

TRANSPORTATION

N Q R W F M A C E 1 6



JAMES FAMULARO

President
646.658.7373
jfamularo@meridiancapital.com

JACOB MAYER

Director
212.468.5926
jmayer@meridiancapital.com

JESSICA BLOCKER

Associate
212.468.5928
jblocker@meridiancapital.com



All information supplied is from sources deemed reliable and is furnished subject to errors, omissions, modifications, removal of the listing from sale or lease, and to any listing conditions, including the rates and manner of payment of commissions for particular offerings imposed by Meridian Capital Group. This information may include estimates and projections prepared by Meridian Capital Group with respect to future events, and these future events may or may not actually occur. Such estimates and projections reflect various assumptions concerning anticipated results. While Meridian Capital Group believes these assumptions are reasonable, there can be no assurance that any of these estimates and projections will be correct. Therefore, actual results may vary materially from these estimates and projections. Any square footage dimensions set forth are approximate.

114 WEST 27TH STREET

CHELSEA, NYC | Between Sixth and Seventh Avenues

RETAIL FOR LEASE

INTERIOR



JAMES FAMULARO

President
646.658.7373
jfamularo@meridiancapital.com

JACOB MAYER

Director
212.468.5926
jmayer@meridiancapital.com

JESSICA BLOCKER

Associate
212.468.5928
jblocker@meridiancapital.com



All information supplied is from sources deemed reliable and is furnished subject to errors, omissions, modifications, removal of the listing from sale or lease, and to any listing conditions, including the rates and manner of payment of commissions for particular offerings imposed by Meridian Capital Group. This information may include estimates and projections prepared by Meridian Capital Group with respect to future events, and these future events may or may not actually occur. Such estimates and projections reflect various assumptions concerning anticipated results. While Meridian Capital Group believes these assumptions are reasonable, there can be no assurance that any of these estimates and projections will be correct. Therefore, actual results may vary materially from these estimates and projections. Any square footage dimensions set forth are approximate.



JAMES FAMULARO

President
646.658.7373
jfamularo@meridiancapital.com

JACOB MAYER

Director
212.468.5926
jmayer@meridiancapital.com

JESSICA BLOCKER

Associate
212.468.5928
jblocker@meridiancapital.com



114 WEST 27TH STREET
CHELSEA, NYC | Between Sixth and Seventh Avenues

RETAIL FOR LEASE

FLOOR PLAN

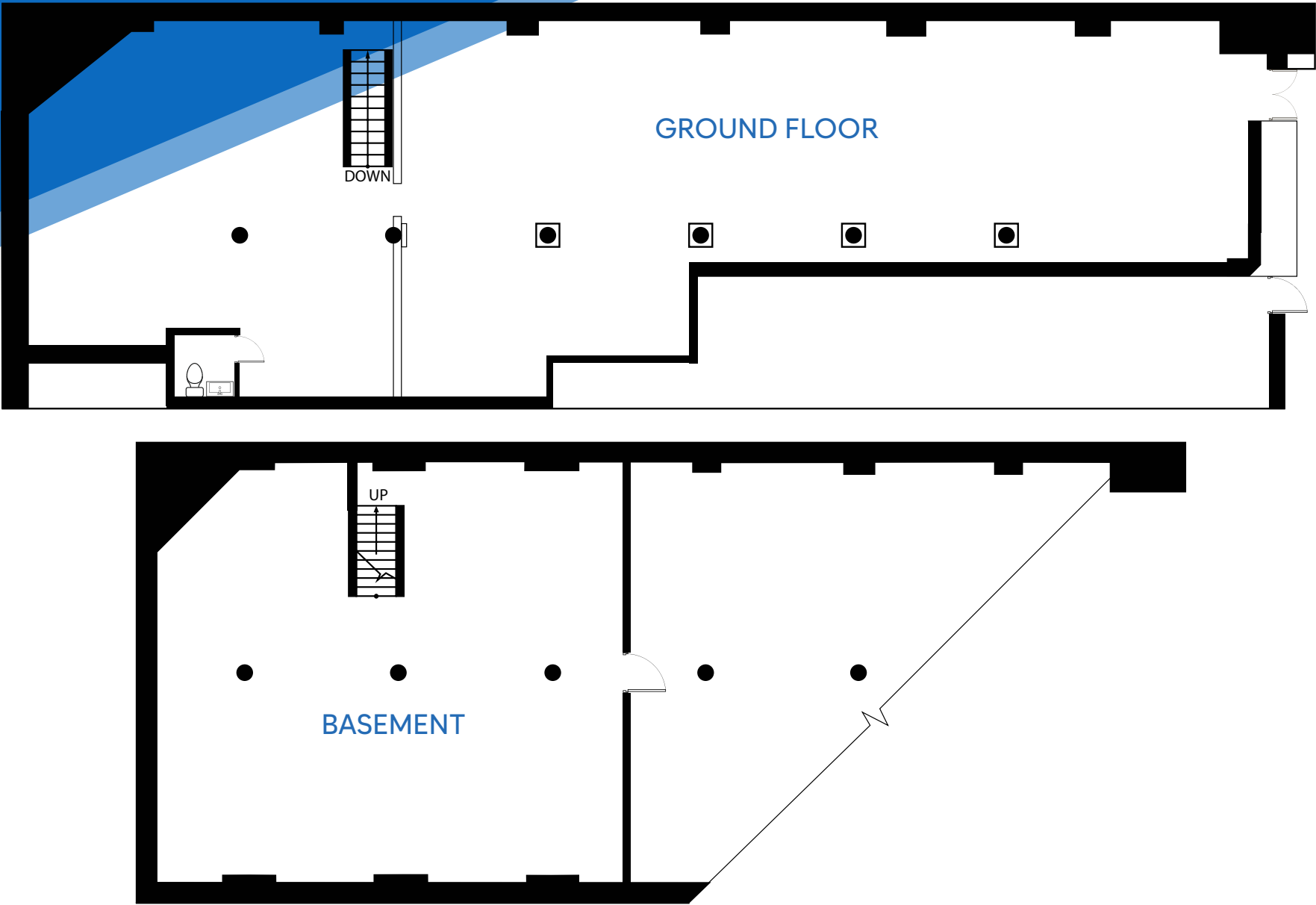

JAMES FAMULARO
President
646.658.7373
jfamularo@meridiancapital.com

JACOB MAYER
Director
212.468.5926
jmayer@meridiancapital.com

JESSICA BLOCKER
Associate
212.468.5928
jblocker@meridiancapital.com



All information supplied is from sources deemed reliable and is furnished subject to errors, omissions, modifications, removal of the listing from sale or lease, and to any listing conditions, including the rates and manner of payment of commissions for particular offerings imposed by Meridian Capital Group. This information may include estimates and projections prepared by Meridian Capital Group with respect to future events, and these future events may or may not actually occur. Such estimates and projections reflect various assumptions concerning anticipated results. While Meridian Capital Group believes these assumptions are reasonable, there can be no assurance that any of these estimates and projections will be correct. Therefore, actual results may vary materially from these estimates and projections. Any square footage dimensions set forth are approximate.



JAMES FAMULARO

President
646.658.7373
jfamularo@meridiancapital.com

JACOB MAYER

Director
212.468.5926
jmayer@meridiancapital.com

JESSICA BLOCKER

Associate
212.468.5928
jblocker@meridiancapital.com