

47

GREAT JONES STREET NOHO, NYC

Between Bowery & Lafayette Street

RETAIL FOR LEASE

APPROXIMATE SIZE

Ground Floor: 2,000 SF
+ Basement

ASKING RENT

~~\$19,000/Month~~ Reduced
\$16,000/Month

POSSESSION

Immediate

TERM

Up to 3 Months

FRONTAGE

15 FT

CEILING HEIGHTS

14 FT

COMMENTS

- Prime NoHo location with heavy foot traffic
- Clean white-box; high ceilings
- Full window display available
- Sidewalk seating permitted
- Short term/pop-ups considered only

NEIGHBORS

Bondst • Zero Bond • Goop • Levain Bakery • Bar Primi • The Wren • Bowery Electric • Sweetgreen • Atelier Jolie • Equinox Bond Street • Kith • Il Buco Alimentari & Vineria • Vic's • Gemma • Jolene

TRANSPORTATION

6 B D F M

JAMES FAMULARO

President

BEN BIBERAJ

Senior Director

703.434.1461

bbiberaj@meridiancapital.com

STEPHEN LIGAMBI

Senior Associate

212.468.5985

sligambi@meridiancapital.com

ELI MARCUS

Associate

212.468.5912

emarcus@meridiancapital.com



All information supplied is from sources deemed reliable and is furnished subject to errors, omissions, modifications, removal of the listing from sale or lease, and to any listing conditions, including the rates and manner of payment of commissions for particular offerings imposed by Meridian Capital Group. This information may include estimates and projections prepared by Meridian Capital Group with respect to future events, and these future events may or may not actually occur. Such estimates and projections reflect various assumptions concerning anticipated results. While Meridian Capital Group believes these assumptions are reasonable, there can be no assurance that any of these estimates and projections will be correct. Therefore, actual results may vary materially from these estimates and projections. Any square footage dimensions set forth are approximate.

47 GREAT JONES STREET

NOHO, NYC | Between Bowery and Lafayette Street

RETAIL FOR LEASE

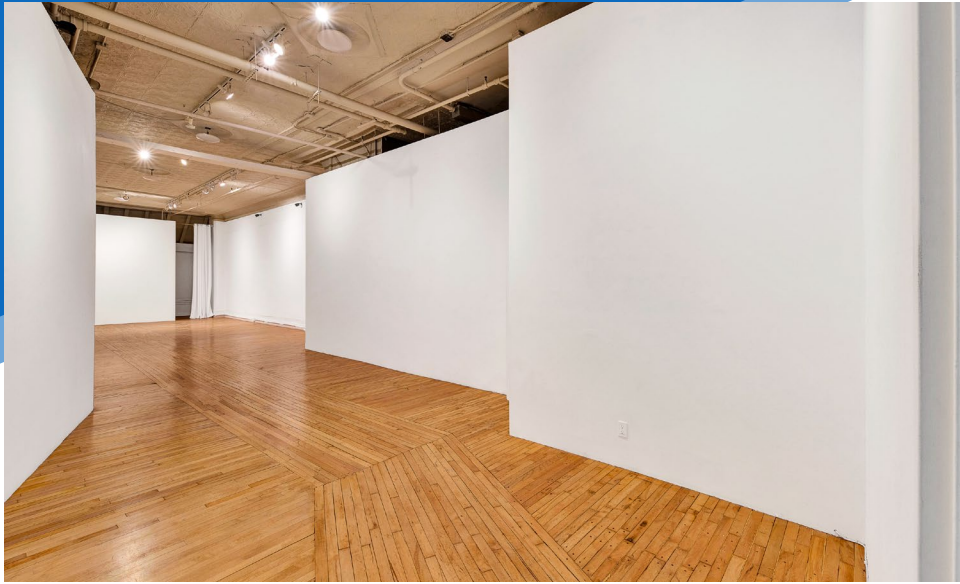

INTERIOR

JAMES FAMULARO
President

BEN BIBERAJ
Senior Director
703.434.1461
bbiberaj@meridiancapital.com

STEPHEN LIGAMBI
Associate
212.468.5985
sligambi@meridiancapital.com

ELI MARCUS
Associate
212.468.5912
emarcus@meridiancapital.com



All information supplied is from sources deemed reliable and is furnished subject to errors, omissions, modifications, removal of the listing from sale or lease, and to any listing conditions, including the rates and manner of payment of commissions for particular offerings imposed by Meridian Capital Group. This information may include estimates and projections prepared by Meridian Capital Group with respect to future events, and these future events may or may not actually occur. Such estimates and projections reflect various assumptions concerning anticipated results. While Meridian Capital Group believes these assumptions are reasonable, there can be no assurance that any of these estimates and projections will be correct. Therefore, actual results may vary materially from these estimates and projections. Any square footage dimensions set forth are approximate.

FLOOR PLAN

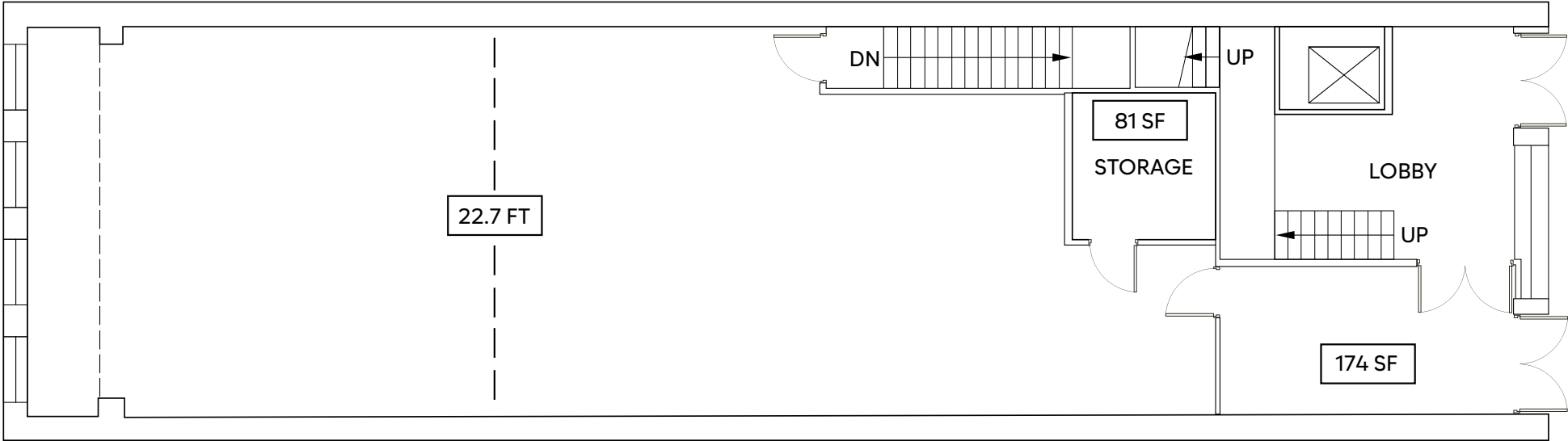

JAMES FAMULARO
President

BEN BIBERAJ
Senior Director
703.434.1461
bbiberaj@meridiancapital.com

STEPHEN LIGAMBI
Senior Associate
212.468.5985
sligambi@meridiancapital.com

ELI MARCUS
Associate
212.468.5912
emarcus@meridiancapital.com



All information supplied is from sources deemed reliable and is furnished subject to errors, omissions, modifications, removal of the listing from sale or lease, and to any listing conditions, including the rates and manner of payment of commissions for particular offerings imposed by Meridian Capital Group. This information may include estimates and projections prepared by Meridian Capital Group with respect to future events, and these future events may or may not actually occur. Such estimates and projections reflect various assumptions concerning anticipated results. While Meridian Capital Group believes these assumptions are reasonable, there can be no assurance that any of these estimates and projections will be correct. Therefore, actual results may vary materially from these estimates and projections. Any square footage dimensions set forth are approximate.

47 GREAT JONES STREET

NOHO, NYC | Between Bowery and Lafayette Street

RETAIL FOR LEASE

NEIGHBORS



JAMES FAMULARO
President

BEN BIBERAJ
Senior Director
703.434.1461
bbiberaj@meridiancapital.com

STEPHEN LIGAMBI
Senior Associate
212.468.5985
sligambi@meridiancapital.com

ELI MARCUS
Associate
212.468.5912
emarcus@meridiancapital.com

MERIDIAN
RETAIL LEASING

All information supplied is from sources deemed reliable and is furnished subject to errors, omissions, modifications, removal of the listing from sale or lease, and to any listing conditions, including the rates and manner of payment of commissions for particular offerings imposed by Meridian Capital Group. This information may include estimates and projections prepared by Meridian Capital Group with respect to future events, and these future events may or may not actually occur. Such estimates and projections reflect various assumptions concerning anticipated results. While Meridian Capital Group believes these assumptions are reasonable, there can be no assurance that any of these estimates and projections will be correct. Therefore, actual results may vary materially from these estimates and projections. Any square footage dimensions set forth are approximate.