

553

EAST 137TH STREET MOTT HAVEN, BRONX

Between Brook & St. Anns's Avenues

RETAIL FOR LEASE



APPROXIMATE SIZE

450 SF + Storage Basement

ASKING RENT

Upon Request

POSSESSION

Immediate

TERM

10+ Years

FRONTAGE

10 FT

COMMENTS

- Turn-key with vent in place
- High foot traffic
- Dense residential population

NEIGHBORS

Dollar Tree • Rainbow • Dunkin' • Mora Bakery
• Valencia Bakery • Tex's Chicken & Burgers
• Willi's Wine Bar • Ray's Pizza Restaurant

TRANSPORTATION

6

M125 **Bx1** **Bx2** **Bx33**

PROPERTY INFORMATION

JAMES FAMULARO
President

BEN BIBERAJ
Senior Director
703.434.1461
bbiberaj@meridiancapital.com

NICK LIZANA
Associate
212.468.5986
nlizana@meridiancapital.com

MERIDIAN
RETAIL LEASING

All information supplied is from sources deemed reliable and is furnished subject to errors, omissions, modifications, removal of the listing from sale or lease, and to any listing conditions, including the rates and manner of payment of commissions for particular offerings imposed by Meridian Capital Group. This information may include estimates and projections prepared by Meridian Capital Group with respect to future events, and these future events may or may not actually occur. Such estimates and projections reflect various assumptions concerning anticipated results. While Meridian Capital Group believes these assumptions are reasonable, there can be no assurance that any of these estimates and projections will be correct. Therefore, actual results may vary materially from these estimates and projections. Any square footage dimensions set forth are approximate.

553 EAST 137TH STREET
MOTT HAVEN, BRONX | Between Brook and St. Anns's Avenues

RETAIL FOR LEASE



INTERIOR

JAMES FAMULARO
President

BEN BIBERAJ
Senior Director
703.434.1461
bbiberaj@meridiancapital.com

NICK LIZANA
Associate
212.468.5986
nlizana@meridiancapital.com



All information supplied is from sources deemed reliable and is furnished subject to errors, omissions, modifications, removal of the listing from sale or lease, and to any listing conditions, including the rates and manner of payment of commissions for particular offerings imposed by Meridian Capital Group. This information may include estimates and projections prepared by Meridian Capital Group with respect to future events, and these future events may or may not actually occur. Such estimates and projections reflect various assumptions concerning anticipated results. While Meridian Capital Group believes these assumptions are reasonable, there can be no assurance that any of these estimates and projections will be correct. Therefore, actual results may vary materially from these estimates and projections. Any square footage dimensions set forth are approximate.

553 EAST 137TH STREET
MOTT HAVEN, BRONX | Between Brook and St. Anns's Avenues

RETAIL FOR LEASE

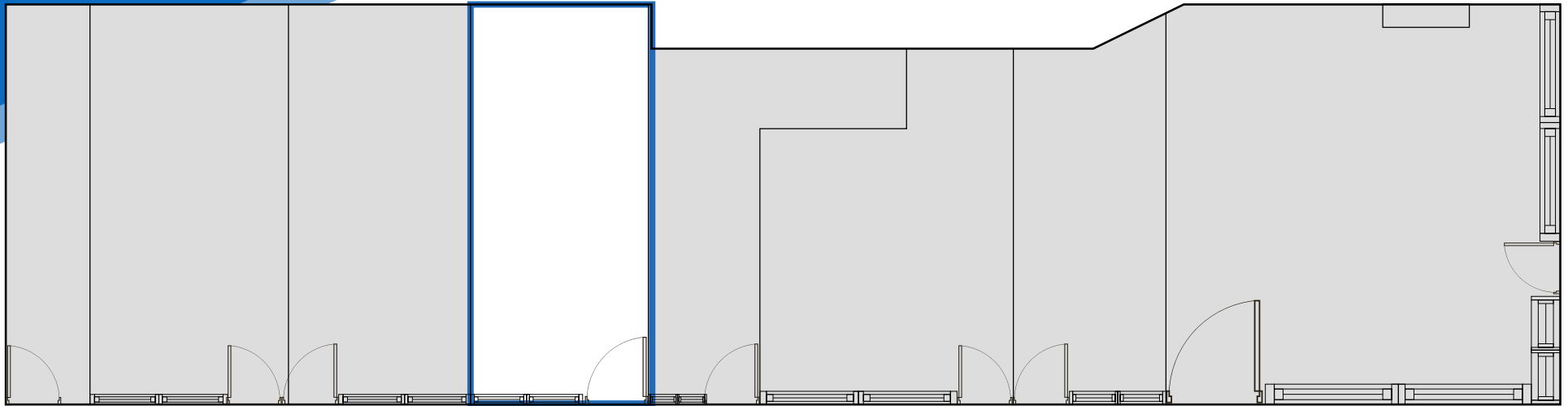

ENTRANCE ON
EAST 137TH STREET

STORAGE BASEMENT

FLOOR PLAN

JAMES FAMULARO
President

BEN BIBERAJ
Senior Director
703.434.1461
bbiberaj@meridiancapital.com

NICK LIZANA
Associate
212.468.5986
nlizana@meridiancapital.com



All information supplied is from sources deemed reliable and is furnished subject to errors, omissions, modifications, removal of the listing from sale or lease, and to any listing conditions, including the rates and manner of payment of commissions for particular offerings imposed by Meridian Capital Group. This information may include estimates and projections prepared by Meridian Capital Group with respect to future events, and these future events may or may not actually occur. Such estimates and projections reflect various assumptions concerning anticipated results. While Meridian Capital Group believes these assumptions are reasonable, there can be no assurance that any of these estimates and projections will be correct. Therefore, actual results may vary materially from these estimates and projections. Any square footage dimensions set forth are approximate.

553 EAST 137TH STREET

MOTT HAVEN, BRONX | Between Brook and St. Anns's Avenues

RETAIL FOR LEASE



NEIGHBORS

JAMES FAMULARO
President

BEN BIBERAJ
Senior Director
703.434.1461
bbiberaj@meridiancapital.com

NICK LIZANA
Associate
212.468.5986
nlizana@meridiancapital.com



All information supplied is from sources deemed reliable and is furnished subject to errors, omissions, modifications, removal of the listing from sale or lease, and to any listing conditions, including the rates and manner of payment of commissions for particular offerings imposed by Meridian Capital Group. This information may include estimates and projections prepared by Meridian Capital Group with respect to future events, and these future events may or may not actually occur. Such estimates and projections reflect various assumptions concerning anticipated results. While Meridian Capital Group believes these assumptions are reasonable, there can be no assurance that any of these estimates and projections will be correct. Therefore, actual results may vary materially from these estimates and projections. Any square footage dimensions set forth are approximate.