

111

JOHN STREET FINANCIAL DISTRICT, NYC

Between Cliff & Pearl Streets

RESTAURANT FOR LEASE



APPROXIMATE SIZE

2,500 SF

ASKING RENT

Upon Request

POSSESSION

Arranged

TERM

10-15 Years

FRONTAGE

30 FT

COMMENTS

- Unused newly built-out restaurant with a high-end omakase speakeasy bar in the rear of the space
- Type 2 venting
- 1AM beer and wine license in place - tenant was previously approved for full liquor license
- \$75K Key-money

NEIGHBORS

Hey Thai • Carvel • Orange Theory • Harry's Italian • Felice • Orange Theory • Chop & Go • Taco Bell • Stout • Pearl Diner • Playa Bowls

TRANSPORTATION

2 3 4 5 A C E J Z



JAMES FAMULARO

President

JOHN ROESCH

Director

212.468.5971

jroesch@meridiancapital.com

KEVIN BISCONTI

Director

212.468.5962

kbisconti@meridiancapital.com



All information supplied is from sources deemed reliable and is furnished subject to errors, omissions, modifications, removal of the listing from sale or lease, and to any listing conditions, including the rates and manner of payment of commissions for particular offerings imposed by Meridian Capital Group. This information may include estimates and projections prepared by Meridian Capital Group with respect to future events, and these future events may or may not actually occur. Such estimates and projections reflect various assumptions concerning anticipated results. While Meridian Capital Group believes these assumptions are reasonable, there can be no assurance that any of these estimates and projections will be correct. Therefore, actual results may vary materially from these estimates and projections. Any square footage dimensions set forth are approximate.



INTERIOR

JAMES FAMULARO
President

JOHN ROESCH
Director
212.468.5971
jroesch@meridiancapital.com

KEVIN BISCONTI
Director
212.468.5962
kbisconti@meridiancapital.com



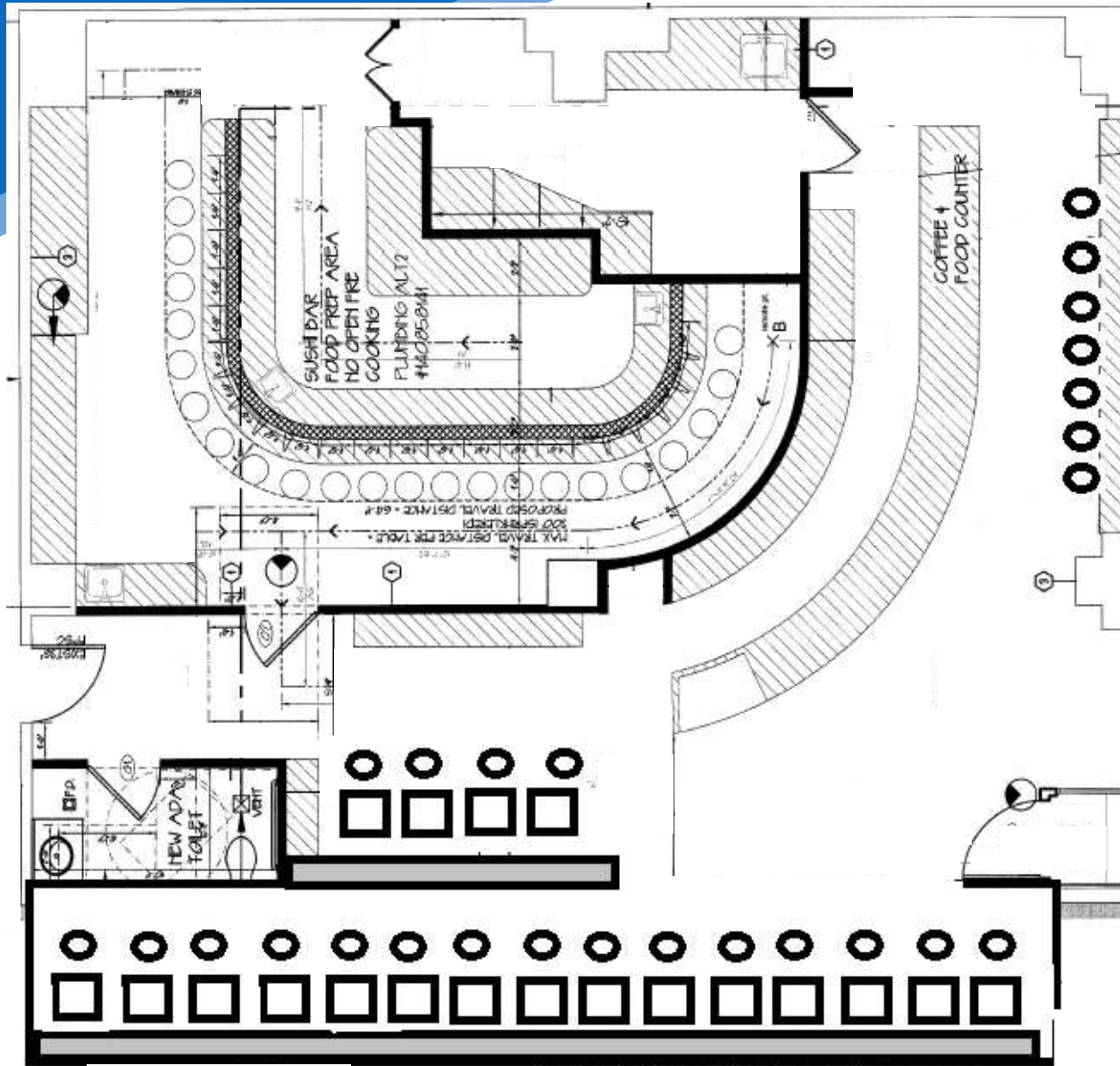

ENTRANCE ON JOHN STREET

JAMES FAMULARO
 President

JOHN ROESCH
 Director
 212.468.5971
 jroesch@meridiancapital.com

KEVIN BISCONTI
 Director
 212.468.5962
 kbisconti@meridiancapital.com



111 JOHN STREET
 FINANCIAL DISTRICT, NYC | Between Cliff and Pearl Streets

RESTAURANT FOR LEASE

NEIGHBORS



JAMES FAMULARO
 President

JOHN ROESCH
 Director
 212.468.5971
 jroesch@meridiancapital.com

KEVIN BISCONTI
 Director
 212.468.5962
 kbisconti@meridiancapital.com



All information supplied is from sources deemed reliable and is furnished subject to errors, omissions, modifications, removal of the listing from sale or lease, and to any listing conditions, including the rates and manner of payment of commissions for particular offerings imposed by Meridian Capital Group. This information may include estimates and projections prepared by Meridian Capital Group with respect to future events, and these future events may or may not actually occur. Such estimates and projections reflect various assumptions concerning anticipated results. While Meridian Capital Group believes these assumptions are reasonable, there can be no assurance that any of these estimates and projections will be correct. Therefore, actual results may vary materially from these estimates and projections. Any square footage dimensions set forth are approximate.