

1674

PARK AVENUE EAST HARLEM, NYC

Corner of Park Avenue & East 118th Street



APPROXIMATE SIZE

Corner (Space A): 1,100 SF

~~Inline (Space B): 660 SF - Leased~~

ASKING RENT

\$4,750/Month

POSSESSION

Immediate

TERM

Negotiable

FRONTAGE

60 FT Wraparound

COMMENTS

- Space A: Corner space formerly a café with wraparound glass frontage
- Plenty of parking nearby
- Both spaces have private bathrooms

NEIGHBORS

Armonie Bistro • Boost Mobile • UPS • House of Candles • Spafiesta • Madison Avenue Laundry

TRANSPORTATION

4 5 6

PROPERTY INFORMATION

JAMES FAMULARO

President
646.658.7373
jfamularo@meridiancapital.com

BOBBY ORTENSE

Associate
212.468.5953
bortense@meridiancapital.com





INTERIOR

JAMES FAMULARO

President
646.658.7373
jfamularo@meridiancapital.com

BOBBY ORTENSE

Associate
212.468.5953
bortense@meridiancapital.com



1674 PARK AVENUE
EAST HARLEM, NYC | Corner of Park Avenue and 118th Street

RETAIL FOR LEASE

FLOOR PLAN

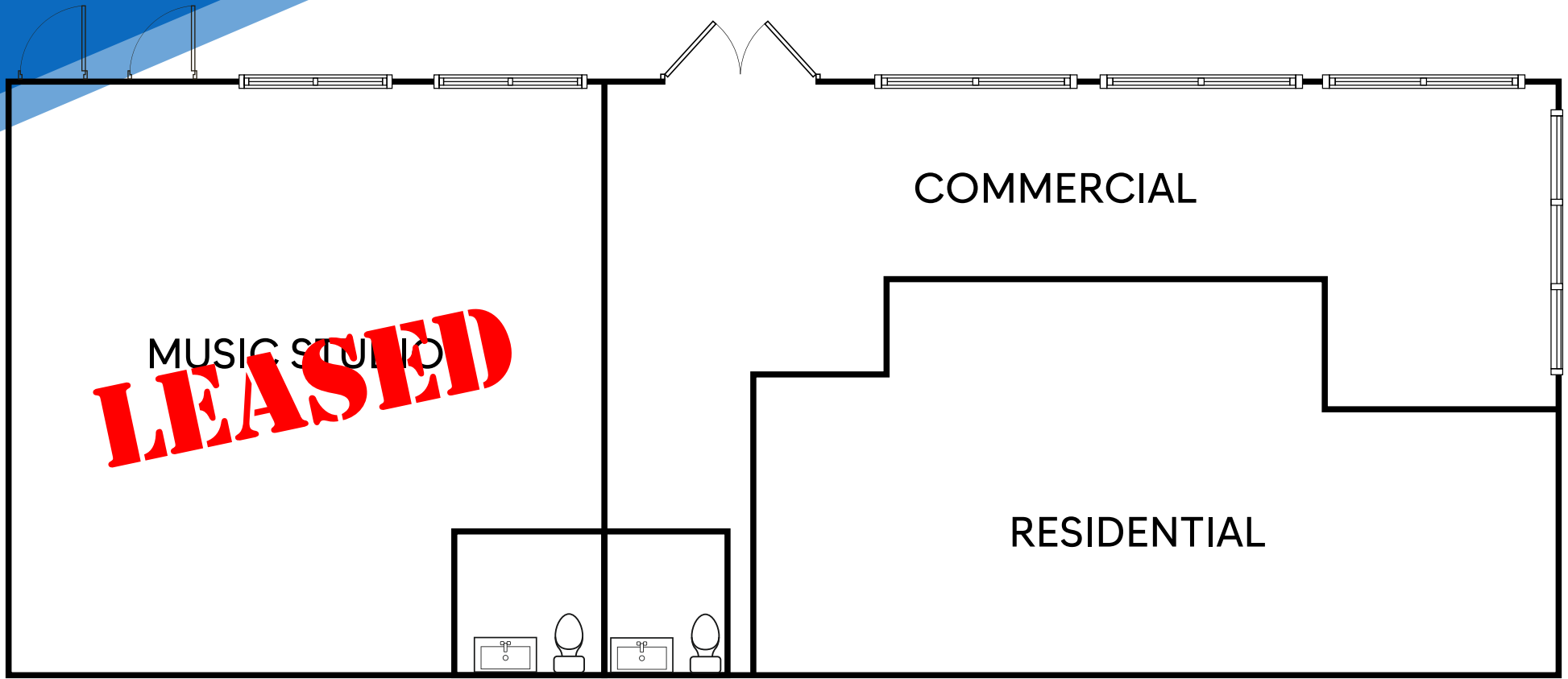

JAMES FAMULARO

President
646.658.7373
jfamularo@meridiancapital.com

BOBBY ORTENSE

Associate
212.468.5953
bortense@meridiancapital.com



All information supplied is from sources deemed reliable and is furnished subject to errors, omissions, modifications, removal of the listing from sale or lease, and to any listing conditions, including the rates and manner of payment of commissions for particular offerings imposed by Meridian Capital Group. This information may include estimates and projections prepared by Meridian Capital Group with respect to future events, and these future events may or may not actually occur. Such estimates and projections reflect various assumptions concerning anticipated results. While Meridian Capital Group believes these assumptions are reasonable, there can be no assurance that any of these estimates and projections will be correct. Therefore, actual results may vary materially from these estimates and projections. Any square footage dimensions set forth are approximate.

1674 PARK AVENUE

EAST HARLEM, NYC | Corner of Park Avenue and 118th Street

RETAIL FOR LEASE

NEIGHBORS

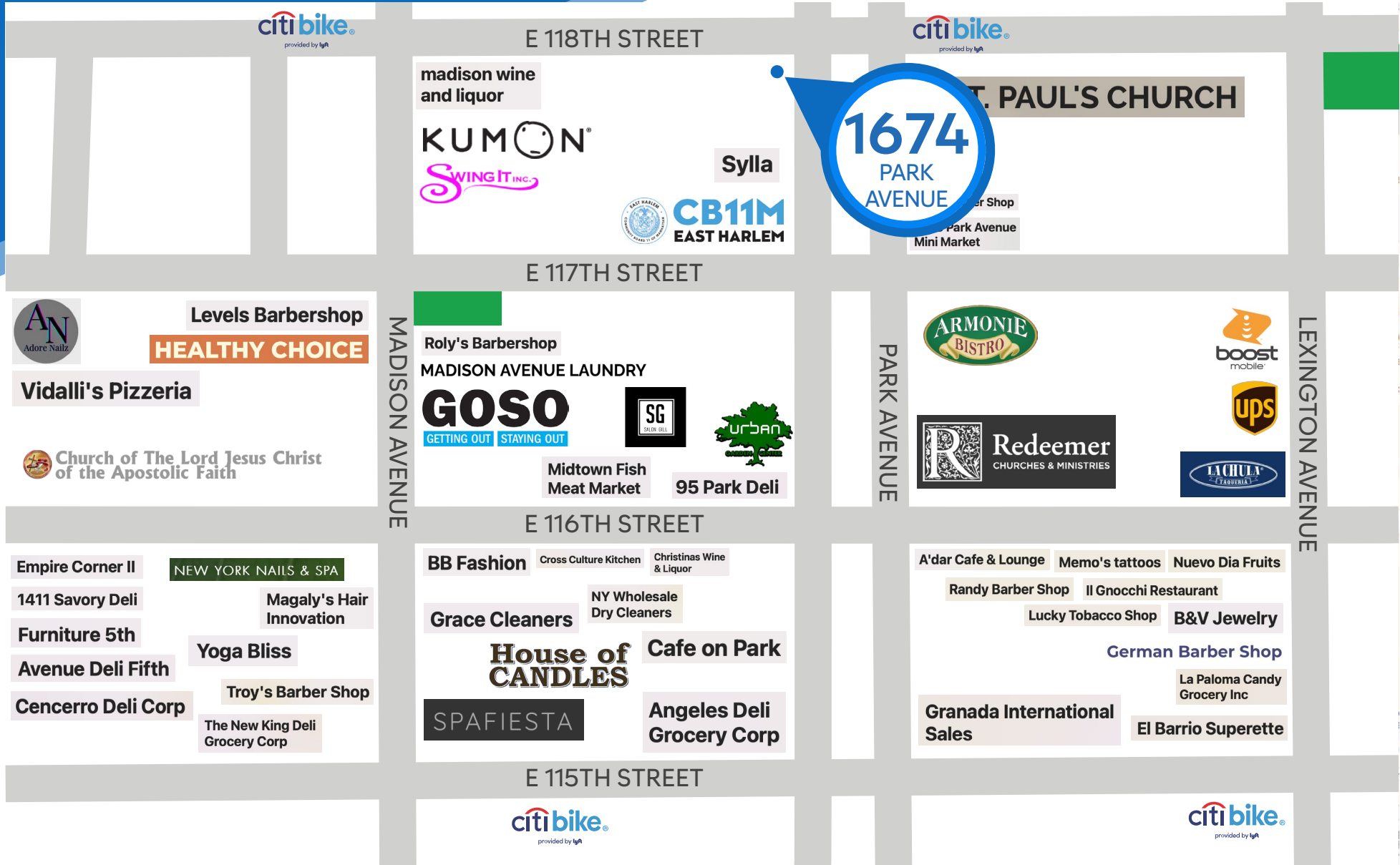

JAMES FAMULARO

President
646.658.7373
jfamularo@meridiancapital.com

BOBBY ORTENSE

Associate
212.468.5953
bortense@meridiancapital.com



All information supplied is from sources deemed reliable and is furnished subject to errors, omissions, modifications, removal of the listing from sale or lease, and to any listing conditions, including the rates and manner of payment of commissions for particular offerings imposed by Meridian Capital Group. This information may include estimates and projections prepared by Meridian Capital Group with respect to future events, and these future events may or may not actually occur. Such estimates and projections reflect various assumptions concerning anticipated results. While Meridian Capital Group believes these assumptions are reasonable, there can be no assurance that any of these estimates and projections will be correct. Therefore, actual results may vary materially from these estimates and projections. Any square footage dimensions set forth are approximate.