

# 350

**BOWERY**  
NOHO, NYC

Between Great Jones & East 4<sup>th</sup> Streets

RESTAURANT/RETAIL FOR LEASE

#### APPROXIMATE SIZE

1,500 SF

#### ASKING RENT

\$17,000/Month

#### POSSESSION

30 Days

#### TERM

10-15 Years

#### FRONTAGE

45 FT

#### COMMENTS

- Space can easily be vented for cooking
- Gas-line available
- Delivered as a clean white-box
- Potential sidewalk seating
- Located right off the corner of Bowery and Great Jones Street

#### NEIGHBORS

Zero Bond • Kissaki • Goop • Levain Bakery • Bar Primi • J Crew • The Wren • Bowery Electric • Lafayette Grand Café & Bakery • Sweetgreen • NYU • Equinox Bond Street • Cooper Square • Kith • Il Buco Alimentari & Vineria • Vic's • Gemma • Jolene

#### TRANSPORTATION



PROPERTY INFORMATION

**JAMES FAMULARO**  
President

**JOHN ROESCH**  
Director  
212.468.5971  
jroesch@meridiancapital.com



All information supplied is from sources deemed reliable and is furnished subject to errors, omissions, modifications, removal of the listing from sale or lease, and to any listing conditions, including the rates and manner of payment of commissions for particular offerings imposed by Meridian Capital Group. This information may include estimates and projections prepared by Meridian Capital Group with respect to future events, and these future events may or may not actually occur. Such estimates and projections reflect various assumptions concerning anticipated results. While Meridian Capital Group believes these assumptions are reasonable, there can be no assurance that any of these estimates and projections will be correct. Therefore, actual results may vary materially from these estimates and projections. Any square footage dimensions set forth are approximate.

# 350 BOWERY

NOHO, NYC | Between Great Jones and East 4<sup>th</sup> Streets

RESTAURANT/RETAIL FOR LEASE



INTERIOR

JAMES FAMULARO  
President

JOHN ROESCH  
Director  
212.468.5971  
jroesch@meridiancapital.com



All information supplied is from sources deemed reliable and is furnished subject to errors, omissions, modifications, removal of the listing from sale or lease, and to any listing conditions, including the rates and manner of payment of commissions for particular offerings imposed by Meridian Capital Group. This information may include estimates and projections prepared by Meridian Capital Group with respect to future events, and these future events may or may not actually occur. Such estimates and projections reflect various assumptions concerning anticipated results. While Meridian Capital Group believes these assumptions are reasonable, there can be no assurance that any of these estimates and projections will be correct. Therefore, actual results may vary materially from these estimates and projections. Any square footage dimensions set forth are approximate.

# 350 BOWERY

NOHO, NYC | Between Great Jones and East 4<sup>th</sup> Streets

RESTAURANT FOR LEASE

FLOOR PLAN

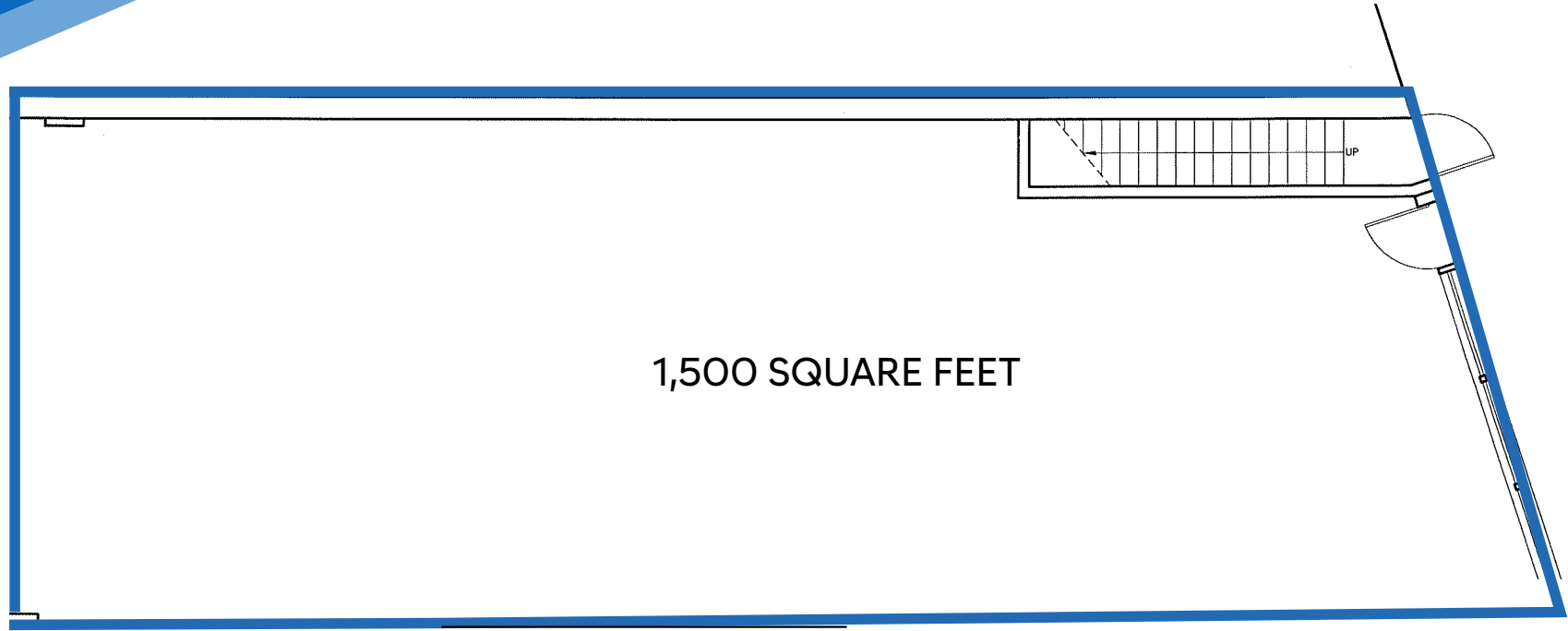

BOWERY

JAMES FAMULARO  
President

JOHN ROESCH  
Director  
212.468.5971  
jroesch@meridiancapital.com



All information supplied is from sources deemed reliable and is furnished subject to errors, omissions, modifications, removal of the listing from sale or lease, and to any listing conditions, including the rates and manner of payment of commissions for particular offerings imposed by Meridian Capital Group. This information may include estimates and projections prepared by Meridian Capital Group with respect to future events, and these future events may or may not actually occur. Such estimates and projections reflect various assumptions concerning anticipated results. While Meridian Capital Group believes these assumptions are reasonable, there can be no assurance that any of these estimates and projections will be correct. Therefore, actual results may vary materially from these estimates and projections. Any square footage dimensions set forth are approximate.

# 350 BOWERY

NOHO, NYC | Between Great Jones and East 4<sup>th</sup> Streets

RESTAURANT FOR LEASE



NEIGHBORS

JAMES FAMULARO  
President

JOHN ROESCH  
Director  
212.468.5971  
jroesch@meridiancapital.com



All information supplied is from sources deemed reliable and is furnished subject to errors, omissions, modifications, removal of the listing from sale or lease, and to any listing conditions, including the rates and manner of payment of commissions for particular offerings imposed by Meridian Capital Group. This information may include estimates and projections prepared by Meridian Capital Group with respect to future events, and these future events may or may not actually occur. Such estimates and projections reflect various assumptions concerning anticipated results. While Meridian Capital Group believes these assumptions are reasonable, there can be no assurance that any of these estimates and projections will be correct. Therefore, actual results may vary materially from these estimates and projections. Any square footage dimensions set forth are approximate.