

# 1568

## SECOND AVENUE UPPER EAST SIDE, NYC

Between East 81<sup>st</sup> & 82<sup>nd</sup> Streets



### APPROXIMATE SIZE

Second Floor: 1,200 SF

### ASKING RENT

\$8,500/Month

### POSSESSION

Immediate

### TERM

10-15 Years

### COMMENTS

- Prime UES location
- Space will be delivered in white-box condition
- Newly renovated
- High foot traffic
- High ceilings
- All dry uses considered

### NEIGHBORS

Insomnia Cookies • Campagna Ristorante • CVS • A Teaz  
• Chip City • Starbucks • Beyond Sushi • Duane Reade •  
New York Public Library • Gristedes • Quality Eats • Dunkin'

### TRANSPORTATION



### JAMES FAMULARO

President  
646.658.7373  
jfamularo@meridiancapital.com







INTERIOR

JAMES FAMULARO  
President  
646.658.7373  
jfamularo@meridiancapital.com



All information supplied is from sources deemed reliable and is furnished subject to errors, omissions, modifications, removal of the listing from sale or lease, and to any listing conditions, including the rates and manner of payment of commissions for particular offerings imposed by Meridian Capital Group. This information may include estimates and projections prepared by Meridian Capital Group with respect to future events, and these future events may or may not actually occur. Such estimates and projections reflect various assumptions concerning anticipated results. While Meridian Capital Group believes these assumptions are reasonable, there can be no assurance that any of these estimates and projections will be correct. Therefore, actual results may vary materially from these estimates and projections. Any square footage dimensions set forth are approximate.

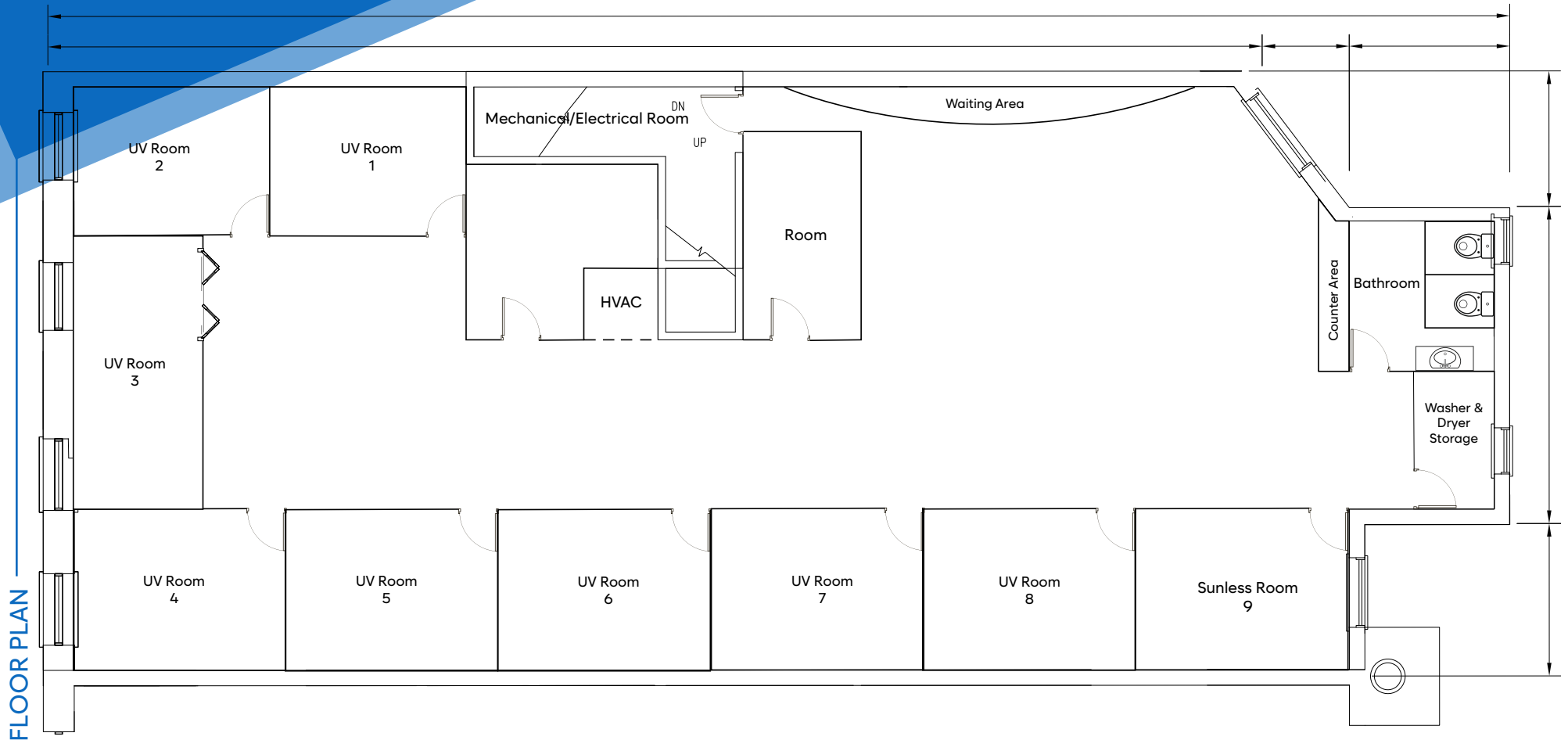

FLOOR PLAN

JAMES FAMULARO

President  
646.658.7373  
jfamularo@meridiancapital.com





1568 SECOND AVENUE  
UPPER EAST SIDE, NYC | Between East 81<sup>st</sup> and 82<sup>nd</sup> Streets

RETAIL FOR LEASE

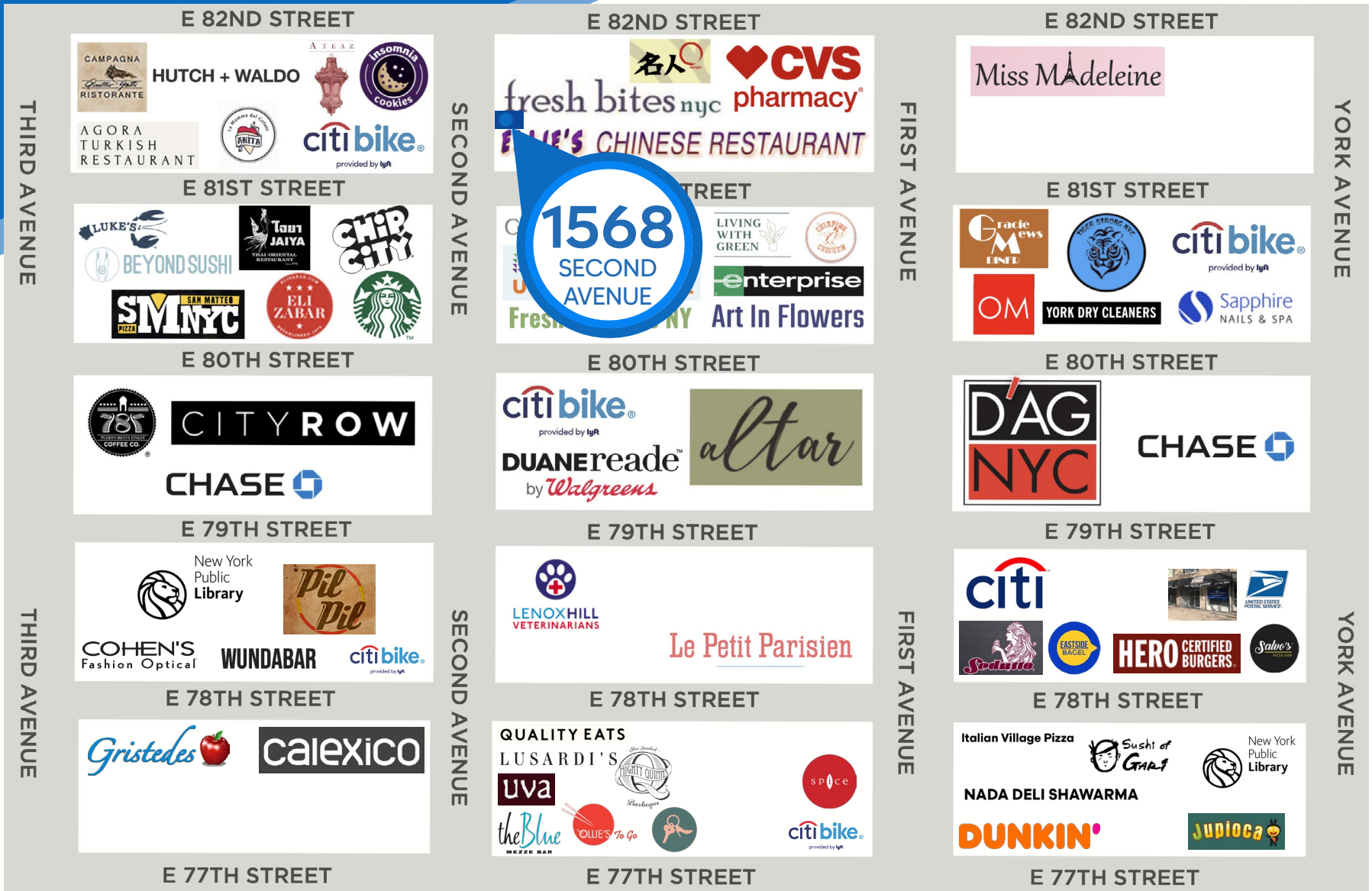

NEIGHBORS

JAMES FAMULARO

President  
646.658.7373  
jfamularo@meridiancapital.com



All information supplied is from sources deemed reliable and is furnished subject to errors, omissions, modifications, removal of the listing from sale or lease, and to any listing conditions, including the rates and manner of payment of commissions for particular offerings imposed by Meridian Capital Group. This information may include estimates and projections prepared by Meridian Capital Group with respect to future events, and these future events may or may not actually occur. Such estimates and projections reflect various assumptions concerning anticipated results. While Meridian Capital Group believes these assumptions are reasonable, there can be no assurance that any of these estimates and projections will be correct. Therefore, actual results may vary materially from these estimates and projections. Any square footage dimensions set forth are approximate.