

736

OCEAN PARKWAY
KENSINGTON, BROOKLYN

Between Parkville & Foster Avenues

LOWER LEVEL MEDICAL SPACE FOR LEASE

APPROXIMATE SIZE

Lower Level: 1,500 SF

ASKING RENT

Upon Request

POSSESSION

Immediate

TERM

Negotiable

FRONTAGE

40 FT

COMMENTS

- Free time offered for renovation
- Wheelchair accessible
- Two large offices
- Kitchen & 2 bathrooms
- Waiting & reception area
- Dense residential population

NEIGHBORS

Kent Theatre • CVS Pharmacy • Papa John's •
Key Food • Milk and Honey Café • McDonald's •
Cinnabon • Dunkin' • Carvel

TRANSPORTATION



JAMES FAMULARO
President

JOSEPH HARARY
Associate
212.468.5978
jharary@meridiancapital.com



All information supplied is from sources deemed reliable and is furnished subject to errors, omissions, modifications, removal of the listing from sale or lease, and to any listing conditions, including the rates and manner of payment of commissions for particular offerings imposed by Meridian Capital Group. This information may include estimates and projections prepared by Meridian Capital Group with respect to future events, and these future events may or may not actually occur. Such estimates and projections reflect various assumptions concerning anticipated results. While Meridian Capital Group believes these assumptions are reasonable, there can be no assurance that any of these estimates and projections will be correct. Therefore, actual results may vary materially from these estimates and projections. Any square footage dimensions set forth are approximate.

736 OCEAN PARKWAY

KENSINGTON, BROOKLYN | Between Parkville and Foster Avenues

LOWER LEVEL MEDICAL SPACE FOR LEASE



INTERIOR

JAMES FAMULARO
President

JOSEPH HARARY
Associate
212.468.5978
jharary@meridiancapital.com



All information supplied is from sources deemed reliable and is furnished subject to errors, omissions, modifications, removal of the listing from sale or lease, and to any listing conditions, including the rates and manner of payment of commissions for particular offerings imposed by Meridian Capital Group. This information may include estimates and projections prepared by Meridian Capital Group with respect to future events, and these future events may or may not actually occur. Such estimates and projections reflect various assumptions concerning anticipated results. While Meridian Capital Group believes these assumptions are reasonable, there can be no assurance that any of these estimates and projections will be correct. Therefore, actual results may vary materially from these estimates and projections. Any square footage dimensions set forth are approximate.

736 OCEAN PARKWAY

KENSINGTON, BROOKLYN | Between Parkville and Foster Avenues

LOWER LEVEL MEDICAL SPACE FOR LEASE

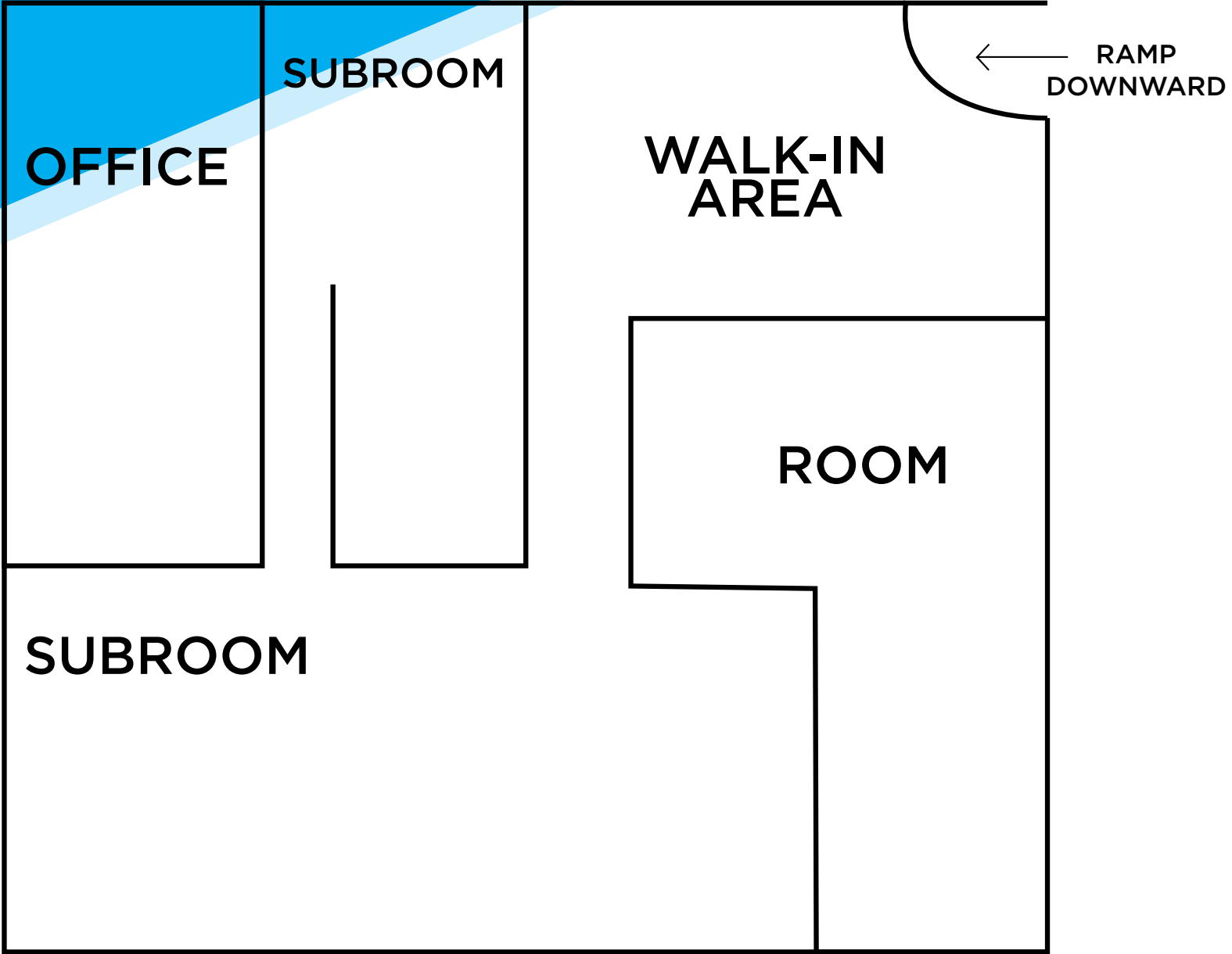

FLOOR PLAN

JAMES FAMULARO
President

JOSEPH HARARY
Associate
212.468.5978
jharary@meridiancapital.com



All information supplied is from sources deemed reliable and is furnished subject to errors, omissions, modifications, removal of the listing from sale or lease, and to any listing conditions, including the rates and manner of payment of commissions for particular offerings imposed by Meridian Capital Group. This information may include estimates and projections prepared by Meridian Capital Group with respect to future events, and these future events may or may not actually occur. Such estimates and projections reflect various assumptions concerning anticipated results. While Meridian Capital Group believes these assumptions are reasonable, there can be no assurance that any of these estimates and projections will be correct. Therefore, actual results may vary materially from these estimates and projections. Any square footage dimensions set forth are approximate.

736 OCEAN PARKWAY

KENSINGTON, BROOKLYN | Between Parkville and Foster Avenues

LOWER LEVEL MEDICAL SPACE FOR LEASE



NEIGHBORS

JAMES FAMULARO
President

JOSEPH HARARY
Associate
212.468.5978
jharary@meridiancapital.com



All information supplied is from sources deemed reliable and is furnished subject to errors, omissions, modifications, removal of the listing from sale or lease, and to any listing conditions, including the rates and manner of payment of commissions for particular offerings imposed by Meridian Capital Group. This information may include estimates and projections prepared by Meridian Capital Group with respect to future events, and these future events may or may not actually occur. Such estimates and projections reflect various assumptions concerning anticipated results. While Meridian Capital Group believes these assumptions are reasonable, there can be no assurance that any of these estimates and projections will be correct. Therefore, actual results may vary materially from these estimates and projections. Any square footage dimensions set forth are approximate.