

160

RIVERSIDE BLVD
UPPER WEST SIDE, NYC

Southwest Corner of West 68th Street

APPROXIMATE SIZE

3,321 SF

ASKING RENT

~~\$17,500/Month~~ Reduced
\$15,000/Month

POSSESSION

Immediate

FRONTAGE

100 FT

TERM

10-15 Years

COMMENTS

- At the base of a luxury tower containing 450 apartments
- Venting and gas lines in place
- Outdoor seating available
- Located in a high-income amenity-rich residential community

NEIGHBORS

Lincoln Center • Harry's Table by Cipriani • Blu Café • Vin Sur Vingt Wine Bar • NYC Elite • Jubilee Marketplace • Renaissance Fine Wines & Spirits • Dwight School • Biscuits & Bath

TRANSPORTATION



PROPERTY INFORMATION

JAMES FAMULARO
President

DANE HARLOWE
Director
212.468.5966
dharlowe@meridiancapital.com

GARRETT KELLY
Director
212.468.5939
gkelly@meridiancapital.com





INTERIOR

JAMES FAMULARO
President

DANE HARLOWE
Director
212.468.5966
dharlowe@meridiancapital.com

GARRETT KELLY
Director
212.468.5939
gkelly@meridiancapital.com



FLOOR PLAN | GROUND FLOOR

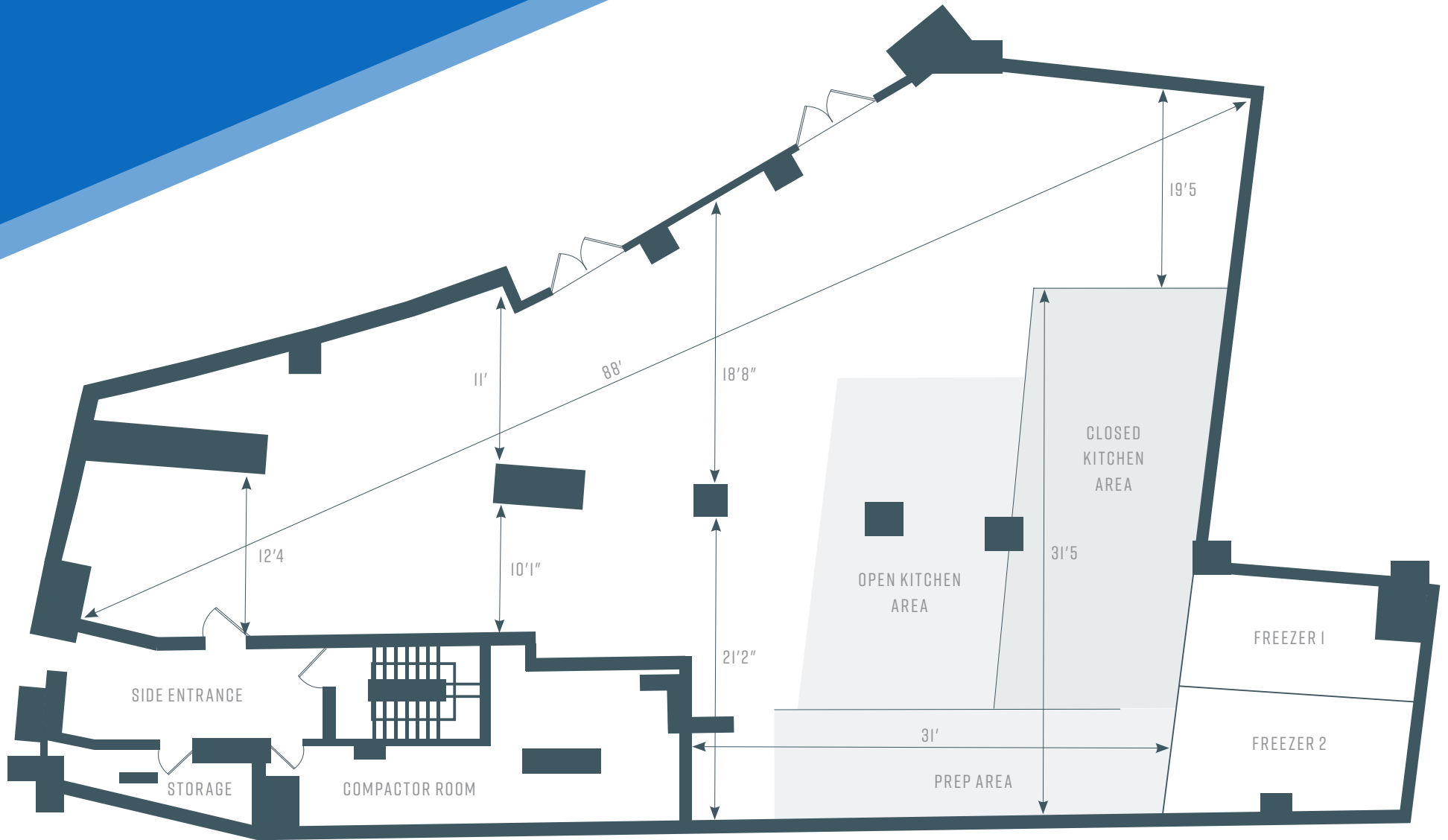

JAMES FAMULARO
President

DANE HARLOWE
Director
212.468.5966
dharlowe@meridiancapital.com

GARRETT KELLY
Director
212.468.5939
gkelly@meridiancapital.com

