

722

BROADWAY

GREENWICH VILLAGE, NYC

Between Washington &
Waverly Place

RETAIL FOR LEASE

APPROXIMATE SIZE

Ground Floor: 1,125 SF + Basement

ASKING RENT

Upon Request

TERM

Negotiable

FRONTAGE

23 FT

POSSESSION

Immediate

COMMENTS

- Prime NYU Greenwich Village
- Heavy Foot Traffic
- All Uses Considered

NEIGHBORS

NYU • Fresh & Co • Foot Locker •
McDonalds • Sweetgreen • Arcadia Earth •
The Donut Pub • Rumble

TRANSPORTATION



JAMES FAMULARO
President

BEN BIBERAJ
Director
bb@meridiancapital.com
703.434.1461

SHLOIME MEISELS
Director
sm@meridiancapital.com
212.468.5964

 **MERIDIAN**
RETAIL LEASING

All information supplied is from sources deemed reliable and is furnished subject to errors, omissions, modifications, removal of the listing from sale or lease, and to any listing conditions, including the rates and manner of payment of commissions for particular offerings imposed by Meridian Capital Group. This information may include estimates and projections prepared by Meridian Capital Group with respect to future events, and these future events may or may not actually occur. Such estimates and projections reflect various assumptions concerning anticipated results. While Meridian Capital Group believes these assumptions are reasonable, there can be no assurance that any of these estimates and projections will be correct. Therefore, actual results may vary materially from these estimates and projections. Any square footage dimensions set forth are approximate.

722 BROADWAY
GREENWICH VILLAGE, NYC
Between Washington & Waverly Place

RETAIL FOR LEASE

INTERIOR



JAMES FAMULARO
President

BEN BIBERAJ
Director
bb@meridiancapital.com
703.434.1461

SHLOIME MEISELS
Director
sm@meridiancapital.com
212.468.5964

MERIDIAN
RETAIL LEASING

All information supplied is from sources deemed reliable and is furnished subject to errors, omissions, modifications, removal of the listing from sale or lease, and to any listing conditions, including the rates and manner of payment of commissions for particular offerings imposed by Meridian Capital Group. This information may include estimates and projections prepared by Meridian Capital Group with respect to future events, and these future events may or may not actually occur. Such estimates and projections reflect various assumptions concerning anticipated results. While Meridian Capital Group believes these assumptions are reasonable, there can be no assurance that any of these estimates and projections will be correct. Therefore, actual results may vary materially from these estimates and projections. Any square footage dimensions set forth are approximate.

722 BROADWAY
GREENWICH VILLAGE, NYC
Between Washington & Waverly Place

RETAIL FOR LEASE

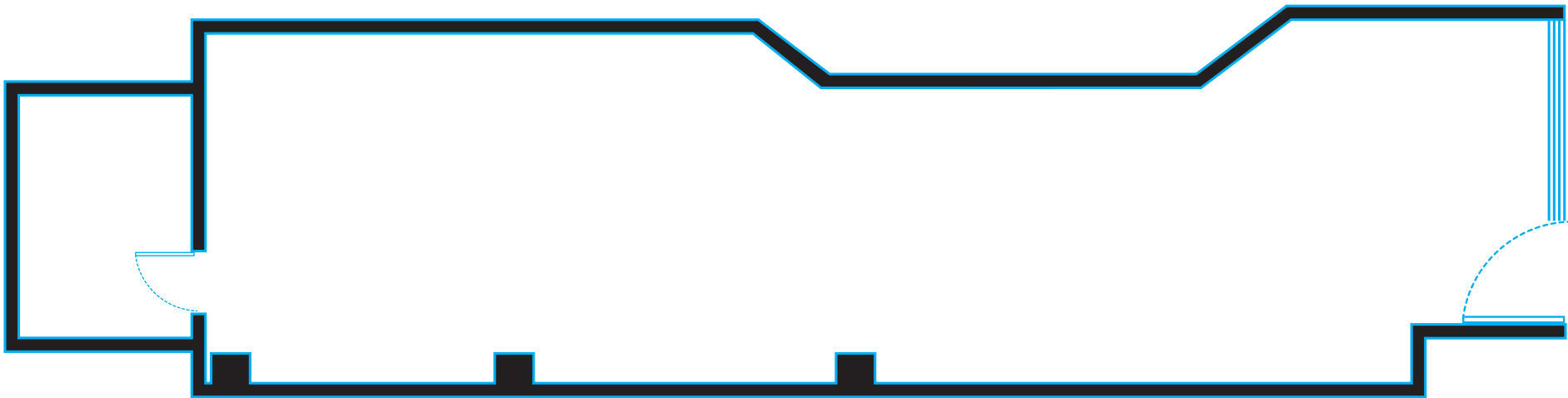

FLOOR PLAN

JAMES FAMULARO President	BEN BIBERAJ Director bb@meridiancapital.com 703.434.1461	SHLOIME MEISELS Director sm@meridiancapital.com 212.468.5964
------------------------------------	--------------------------------------------------------------------------	------------------------------------------------------------------------------



All information supplied is from sources deemed reliable and is furnished subject to errors, omissions, modifications, removal of the listing from sale or lease, and to any listing conditions, including the rates and manner of payment of commissions for particular offerings imposed by Meridian Capital Group. This information may include estimates and projections prepared by Meridian Capital Group with respect to future events, and these future events may or may not actually occur. Such estimates and projections reflect various assumptions concerning anticipated results. While Meridian Capital Group believes these assumptions are reasonable, there can be no assurance that any of these estimates and projections will be correct. Therefore, actual results may vary materially from these estimates and projections. Any square footage dimensions set forth are approximate.

722 BROADWAY
GREENWICH VILLAGE, NYC
Between Washington & Waverly Place

RETAIL FOR LEASE



YOUR NEIGHBORS

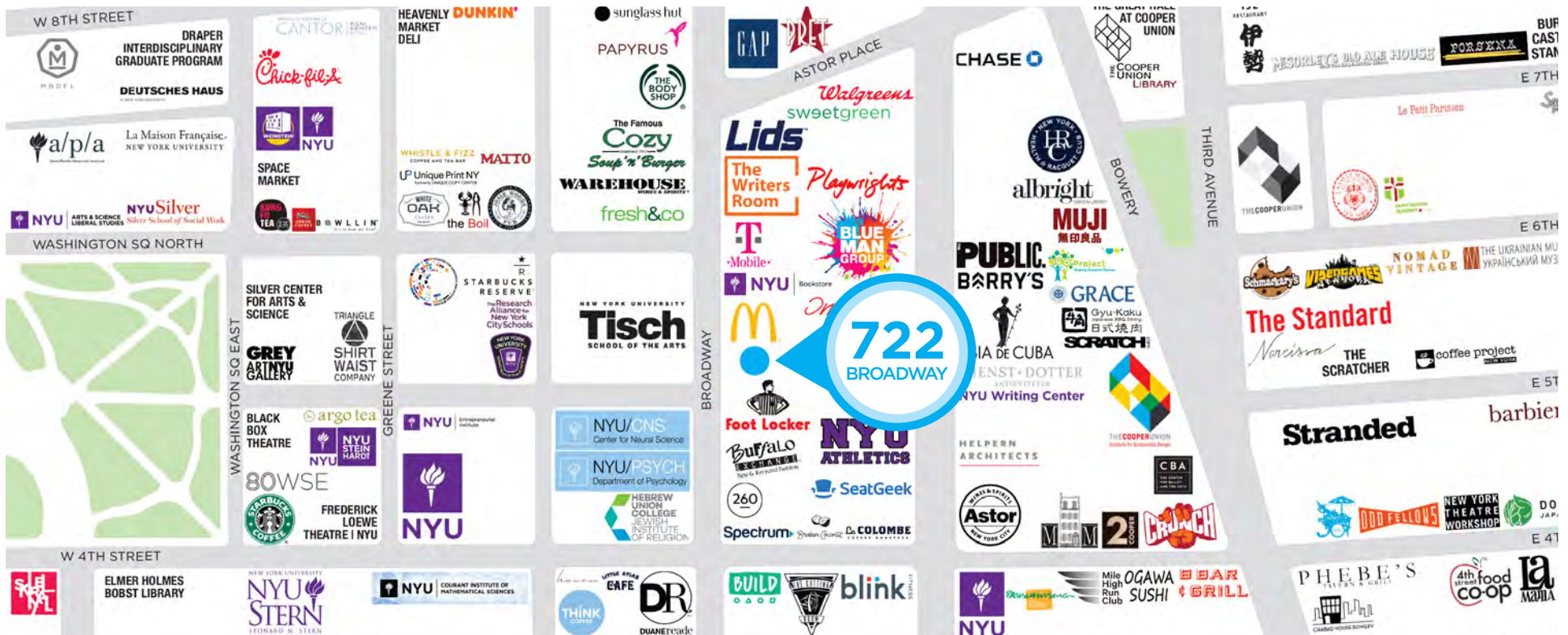

JAMES FAMULARO
President

BEN BIBERAJ
Director
bb@meridiancapital.com
703.434.1461

SHLOIME MEISELS
Director
sb@meridiancapital.com
212.468.5964

MERIDIAN
RETAIL LEASING

All information supplied is from sources deemed reliable and is furnished subject to errors, omissions, modifications, removal of the listing from sale or lease, and to any listing conditions, including the rates and manner of payment of commissions for particular offerings imposed by Meridian Capital Group. This information may include estimates and projections prepared by Meridian Capital Group with respect to future events, and these future events may or may not actually occur. Such estimates and projections reflect various assumptions concerning anticipated results. While Meridian Capital Group believes these assumptions are reasonable, there can be no assurance that any of these estimates and projections will be correct. Therefore, actual results may vary materially from these estimates and projections. Any square footage dimensions set forth are approximate.